

FOI # 2

April 8, 2014

Mr. Mike Smith, P.E.
Iowa Department of Natural Resources
Land Quality Bureau
Wallace State Office Building
502 East 9th Street
Des Moines, Iowa 50319-0034

**Re: Spring 2014 Semi-Annual Inspection Report
Hamilton County Sanitary Landfill (Closed)
Permit No. 40-SDP-02-75C
Project No. HAMSW 14001**

Dear Mike:

This brief report documents the semi-annual inspection required by the closed Hamilton County Sanitary Landfill's Iowa Department of Natural Resources Sanitary Disposal Closure Permit and the Iowa Administrative Code. The semi-annual inspection was made to evaluate the site's general conformance with the permit and the approved plans and specifications.

If you have any questions regarding this report, please contact us at (515) 256-8814.

Sincerely,
BARKER LEMAR ENGINEERING CONSULTANTS



David G. Phillips, P.E.
Project Engineer



Brian L. Rath, P.E.
Project Manager

Copies: Addressee
Mr. Terry Klaver, Hamilton County Sanitary Landfill
Mr. Curt Martin, P.E., Schlotfeldt Engineering
File

M:\HAMSW14001\Documents\Phase 12- Spring Landfill Inspection\HAMSW Spring 2014 Inspect CL.doc

**Site Inspection Report
Spring 2014**

**Hamilton County Sanitary Landfill
Kamrar, Iowa
Permit No. 40-SDP-02-75C
Project No. HAMS W 14001**

Prepared For:

Hamilton County Solid Waste Commission

Prepared By:

**BARKER LEMAR ENGINEERING CONSULTANTS
1801 Industrial Circle
West Des Moines, Iowa 50265
Phone: 515-256-8814
Fax: 515-256-0152**

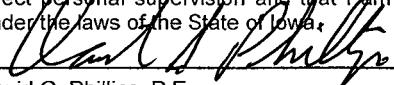
	<p>I hereby certify that this engineering document was prepared by me or under my direct personal supervision and that I am a duly licensed Professional Engineer under the laws of the State of Iowa.</p>
	<p> _____ Date: <u>4/8/14</u></p> <p>David G. Phillips, P.E. License No. 15541 My license renewal date is December 31, 2014 Pages or sheets covered by this seal: Entire document. _____</p>

1.0 Introduction

The closed Hamilton County Sanitary Landfill was inspected on March 20, 2014 by David G. Phillips, P.E. The maintenance of the Hamilton County Sanitary Landfill appeared to be in general conformance with the items listed in the General Provisions and Special Provisions sections of the August 18, 2008 closure permit. Specific items relating to observed conditions and non-conformance items are discussed below. A site map (Figure 1) used during the inspection is included for reference. A checklist used as a guide during the inspection is included in Attachment A.

Terry Klaver, Landfill Manager, was present during the inspection.

2.0 Observed Conditions

The following summarizes the maintenance activities and inspection observations made during the site inspection:

- Most of the landfill is covered with established vegetation; however, several areas lacking vegetation were observed in the southwest corner of the landfill. Evidence of minor erosion was observed in some of these areas. Mr. Klaver said that soil samples were collected from these areas, were laboratory tested in late 2013, and that the appropriate soil amendments/fertilization, seeding, and mulching will be conducted during the seeding season.
- At the time of the inspection, the vegetation appeared to be dormant and the ground appeared to be mostly frozen.
- It was noted by Mr. Klaver that the Iowa Department of Natural Resources (Department) is no longer requiring a perimeter fence, thus, portions of the fence that had been removed for maintenance/repair or construction activities will not be replaced. Mr. Klaver said that, in addition to the "No Trespassing" signs that have been posted on gates and fences, similar signs will also be posted along the southern boundary where the fence had been removed.
- There was no observed evidence of leachate seeps.

3.0 Non-Conformance with Permit Conditions

No items of non-conformance with the permit conditions were noted at the time of the inspection.

4.0 General Comments

The observations presented in this report were based upon data obtained from the field observations made at the site, interviews with the site operator, and from information sources discussed in this report. This report provides a snapshot in time of the conditions present at the time of the inspection and does not reflect variations in conditions that may occur throughout the year.

BARKER LEMAR ENGINEERING CONSULTANTS has prepared this report for the exclusive use of our client. The report is meant for the specific application discussed and has been prepared in accordance with generally accepted engineering practices. No warranties, express or implied, are intended or made.

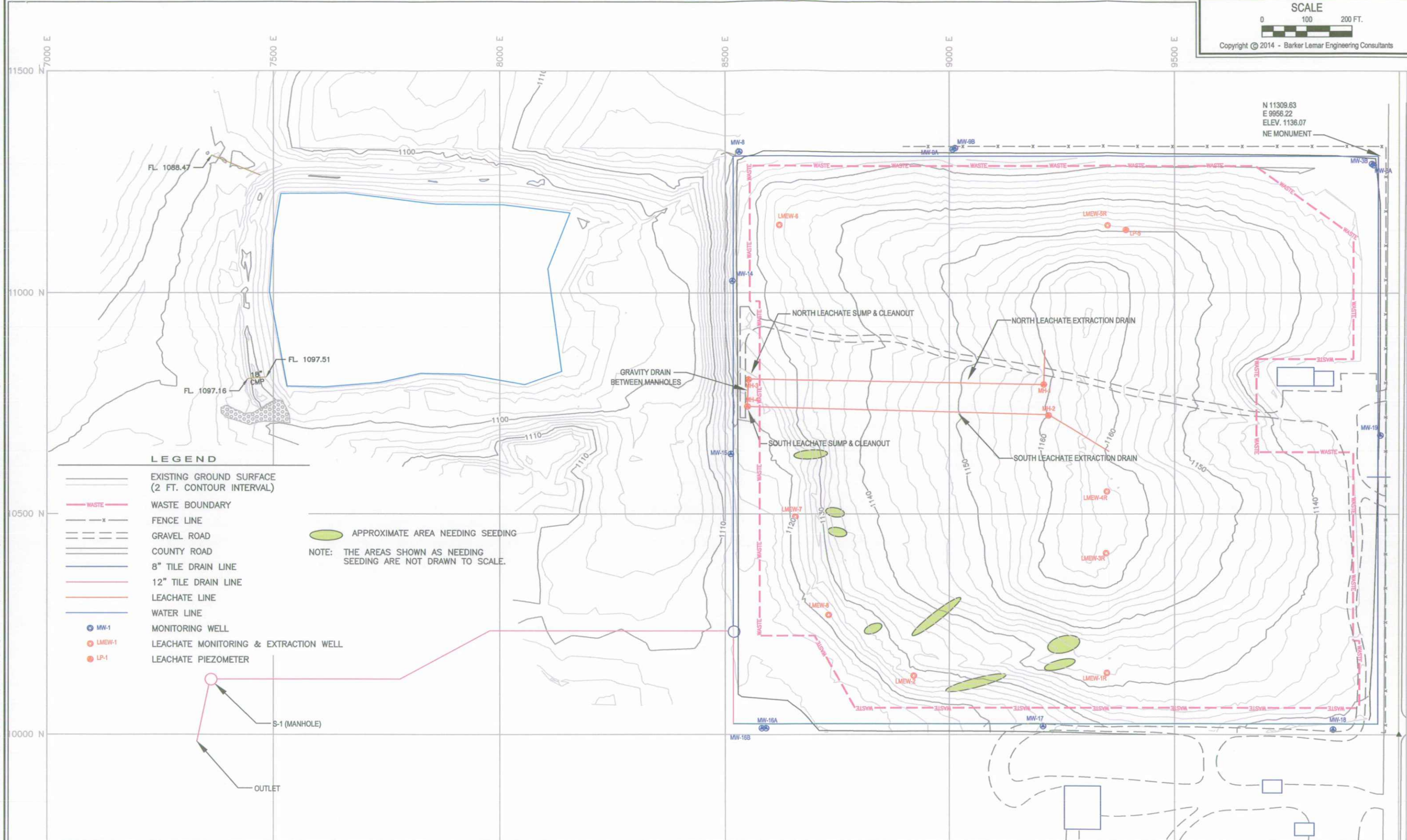

LEGEND

- EXISTING GROUND SURFACE (2 FT. CONTOUR INTERVAL)
- WASTE BOUNDARY
- FENCE LINE
- GRAVEL ROAD
- COUNTY ROAD
- 8" TILE DRAIN LINE
- 12" TILE DRAIN LINE
- LEACHATE LINE
- WATER LINE
- MW-1 MONITORING WELL
- LMEW-1 LEACHATE MONITORING & EXTRACTION WELL
- LP-1 LEACHATE PIEZOMETER

APPROXIMATE AREA NEEDING SEEDING
NOTE: THE AREAS SHOWN AS NEEDING SEEDING ARE NOT DRAWN TO SCALE.

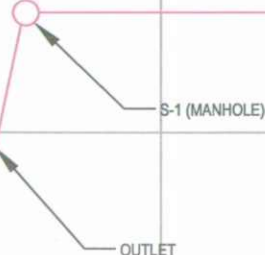

- REFERENCE:**
- PLAN SHEETS DEVELOPED BY SCHLOTFELDT ENGINEERING INC., WEBSTER CITY, IOWA.
 - SITE MAP FIGURE-1, TERRACON ENVIRONMENTAL, INC., DES MOINES, IOWA, 2/15/96.
 - GROUND SURVEY, BARKER LEMAR ENGINEERING CONSULTANTS, OCTOBER 27, 2007.
 - GROUND SURVEY, BARKER LEMAR ENGINEERING CONSULTANTS, OCTOBER 01, 2008.
 - GROUND SURVEY, BARKER LEMAR ENGINEERING CONSULTANTS, DECEMBER 23, 2008.
 - GROUND SURVEY, BARKER LEMAR ENGINEERING CONSULTANTS, MARCH 05, 2009.
 - GROUND SURVEY, BARKER LEMAR ENGINEERING CONSULTANTS, FEBRUARY 20, 2013.

REVISION	DATE	DESCRIPTION
1		
2		
3		
4		

HAMILTON COUNTY SANITARY LANDFILL
KAMRAR, IOWA
PROJECT NO. HAMS 14001
DRAWING DATE: APRIL 2014

**SITE INSPECTION
MARCH 20, 2014**

File name: M:\HAMS\14001\CAD\Phase 12- Spring Landfill Inspection\Spring 2014 Inspection Map.dwg - Last Edited: Apr 02, 2014 14:50 - By: dphillips



ATTACHMENT A
INSPECTION CHECKLIST

SOLID WASTE LANDFILLS OBSERVATION CHECKLIST

B. HYDROGEOLOGICAL MONITORING SYSTEM PLAN

- 1) Has a hydrogeologic study been completed for the landfill?
- 2) Has a monitoring system plan been completed?
- 3) Are monitoring wells in good condition?
- 4) Are monitoring wells marked and identified?
- 5) Have monitoring wells/surface points been sampled according to the permit schedule?
- 6) Have the water sample test results been submitted to IDNR?

Yes	No	Comments
X		
X		
X		
X		
X		
X		

C. LEACHATE CONTROL

- 1) Has the landfill submitted plans/specifications for a leachate collection/treatment system?
- 2) Has the approved leachate collection and treatment system been constructed?
- 3) Does the landfill have permit from the local POTW to discharge leachate?

Yes	No	Comments
X		
X		
X		

D. MISCELLANEOUS REQUIREMENTS

- 1) Is a certified landfill operator on site?
- 2) Has a Closure/Post-Closure Plan been submitted to IDNR?
- 3) Are the SWA reports completed/submitted to IDNR quarterly?
- 4) Has the landfill received petroleum contaminated soil recently?
- 5) Has a quarterly soil sample been collected/analyzed of the aerated petroleum impacted soil?
- 6) Does the landfill have a permit amendment for recycling?

Yes	No	Comments
		NA
X		
		NA
		NA
		NA
		NA

Note:

NA - Not applicable to closed landfill being inspected.