



Metro Park West Landfill

Spring 2025 Semi-Annual Engineering Report July 9, 2025

2499 337th Street
Perry, Iowa 50220



Metro Waste Authority



www.hdrinc.com

(515) 280-4940

300 E. Locust Street, Suite 210
Des Moines, IA 50309

July 9, 2025

Mr. Mike Smith, PE
Iowa Department of Natural Resources
Land Quality Bureau
Wallace State Office Building
502 East 9th Street
Des Moines, Iowa 50319

RE: Spring 2025 Semi-Annual Engineer Observation Report
Metro Park West Greene County Closed Landfill
Permit #08-SDP-03-84P

Dear Mr. Smith:

HDR Engineering, Inc. (HDR) appreciates the opportunity to submit this Semi-Annual Engineering Report (SAER) to the Iowa Department of Natural Resources (IDNR) on behalf of the Metro Waste Authority (MWA). This Spring 2025 SAER was conducted for the Metro Park West (MPW) Greene County Closed Landfill located in Perry, Iowa. It was prepared based on our observation of the MPW Greene County Closed Landfill for the purpose of assessing general conformance with the facility operating permit, plans, and specifications and pursuant to 567 IAC 113 regulations.

HDR has prepared and attached the appropriate excerpted portions of the IDNR Sanitary Disposal Project Inspection Form, Form 542-3160, as a summary of our site observations during the May 13, 2025 site inspection. Areas of special interest noted during the site inspection are highlighted below with locations provided on Figure 1:

- The MPW operating permit was renewed in August of 2021. A copy of the permit renewal documentation and operating permit were available on site and available through MWA's electronic database.
- Record documents are maintained on site or electronically with Metro Waste Authority.
- Appropriate signage and security are present at the MPW facility.
- Signs of rodents or other vectors were not observed at the Greene County Closed Landfill.
- Growth of saplings was observed within two of the letdowns, as shown in Figure 1. It appears that saplings that were identified in previous inspections had been addressed by MWA staff and new saplings have since sprouted up. It is recommended to remove the saplings from the noted locations in the coming weeks and continue to monitor for additional sapling growth.

- Distressed vegetation was observed at the locations shown on the attached Figure 1. It is recommended to re-seed these areas and continue monitoring for vegetative growth. MWA has made multiple attempts to re-seed this area without a strong vegetative response. MWA plans to add topsoil and compost to this area and re-seed in Fall 2025.
- No ponding water was observed on the MPW Greene County Closed Landfill throughout the inspection.
- No leachate seeps were observed on the MPW Greene County Closed Landfill throughout the inspection.

Based on our site observations, the Greene County Closed Landfill is in general compliance with the site permit. If you have questions regarding this report, please feel free to contact Katie Kinley at 402.392.6980 or myself at 402.238.5389.

Sincerely,
HDR Engineering, Inc.



Katie Kinley, P.E.
Project Manager



Aaron Brewer
Assistant Project Manager

cc: Mr. Matthew Morris, MWA
Mr. Andrew Phillips, MWA

Attachment: IDNR Sanitary Disposal Project Inspection Form

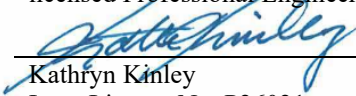
	<p>I hereby certify that this engineering document was prepared by me or under my direct personal supervision and that I am a duly licensed Professional Engineer under the laws of the State of Iowa.</p> <p> Kathryn Kinley Iowa License No. P26021 My license renewal date is December 31, 2025.</p> <p>Pages or sheets covered by this seal: All.</p> <p>7/9/2025 Date</p>
---	--

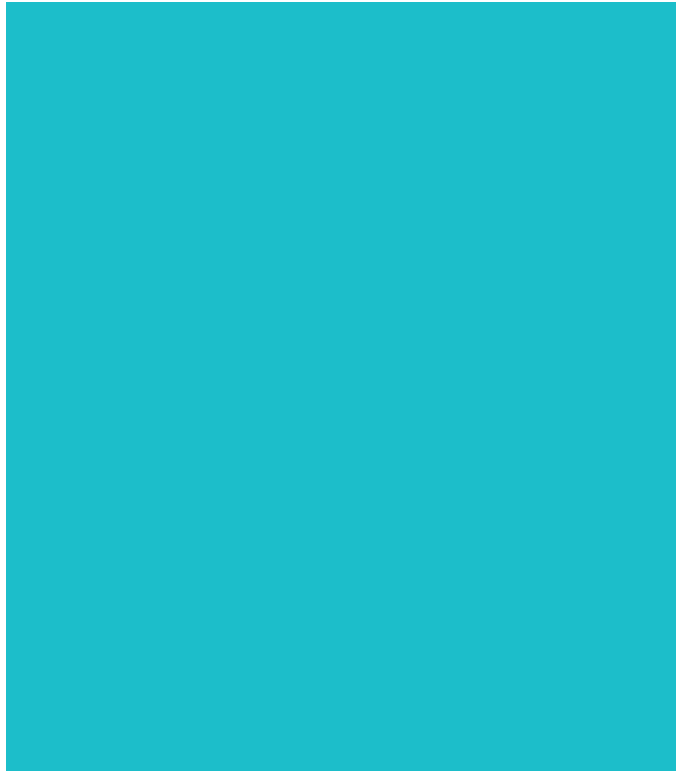
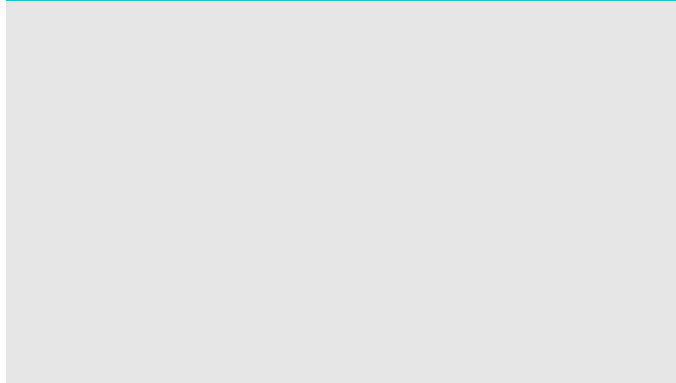
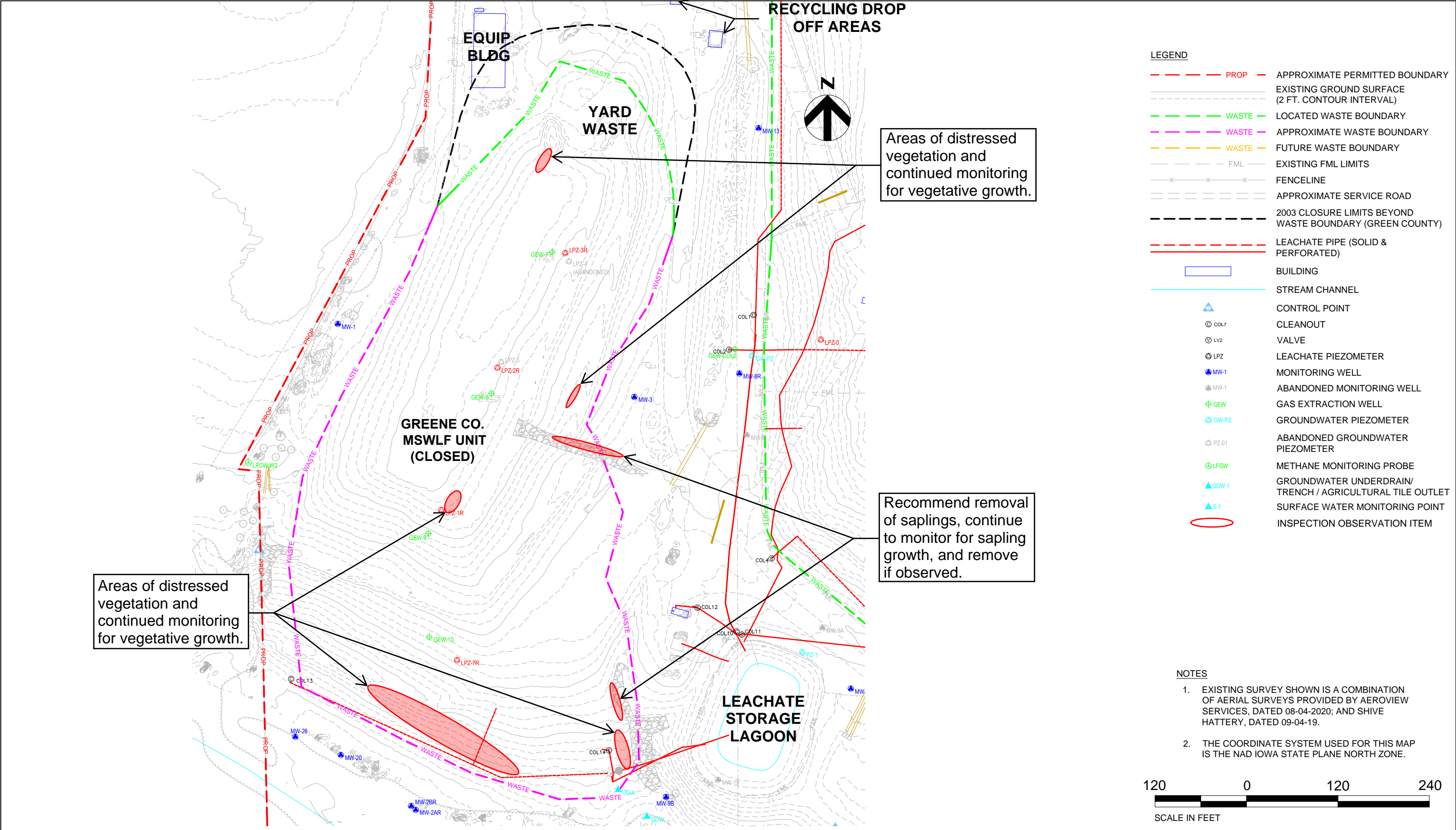

Figure 1

Site Map







Attachment A

Iowa Department of Natural
Resources

Sanitary Disposal Project
Inspection Checklist

IOWA DEPARTMENT OF NATURAL RESOURCES
Sanitary Disposal Project Inspection

Permit #: 08-SDP-03-84P

Page 1

Facility Name: Metro Park West Landfill - Greene Co MSWLF
Unit: _____
County: Greene
Facility Operator: Metro Waste Authority
Address: 2499 337th Street, Perry, Iowa 50220
Phone: (515) 436-8252

Responsible Official: Michael McCoy, Executive Director

Address: 300 E. Locust Street, Des Moines, IA, 50309

Phone: (515) 323-6535

Date Last Inspection: September 27, 2024

Date This Inspection: May 13, 2025

Waste Amount: N/A - Closed MSWLF Unit

At the Time of this Inspection:

- **facility personnel present:** N/A
- **active unit(s):** N/A - Closed MSWLF Unit
- **surface conditions:** N/A - Closed Landfill Inspections
- **ambient temperature:** 85 degrees F
- **wind direction and speed:** 5-10 mph from S

Yes – compliance was being achieved; **No** – compliance was not being achieved,
N/A – not applicable or not observed; **PND** – previously noted deficiency (PND).

I. Documents and Record Keeping:

Yes	No	N/A	PND	Item	Yes	No	N/A	PND	Item
<input checked="" type="checkbox"/>	<input type="checkbox"/>	<input type="checkbox"/>	<input type="checkbox"/>	1. Permit/Amendment documents	<input checked="" type="checkbox"/>	<input type="checkbox"/>	<input type="checkbox"/>	<input type="checkbox"/>	9. Financial assurance
<input checked="" type="checkbox"/>	<input type="checkbox"/>	<input type="checkbox"/>	<input type="checkbox"/>	2. Site exploration report	<input checked="" type="checkbox"/>	<input type="checkbox"/>	<input type="checkbox"/>	<input type="checkbox"/>	10. Storm water permit
<input checked="" type="checkbox"/>	<input type="checkbox"/>	<input type="checkbox"/>	<input type="checkbox"/>	3. Plans/Specs and QC&A Reports	<input checked="" type="checkbox"/>	<input type="checkbox"/>	<input type="checkbox"/>	<input type="checkbox"/>	11. SWA/SWAC documentation
<input checked="" type="checkbox"/>	<input type="checkbox"/>	<input type="checkbox"/>	<input type="checkbox"/>	4. Waste screening inspection records	<input checked="" type="checkbox"/>	<input type="checkbox"/>	<input type="checkbox"/>	<input type="checkbox"/>	12. Operator Certification
<input type="checkbox"/>	<input type="checkbox"/>	<input checked="" type="checkbox"/>	<input type="checkbox"/>	5. Leachate recirculation authorization	<input checked="" type="checkbox"/>	<input type="checkbox"/>	<input type="checkbox"/>	<input type="checkbox"/>	13. DOPs
<input checked="" type="checkbox"/>	<input type="checkbox"/>	<input type="checkbox"/>	<input type="checkbox"/>	6. Gas monitoring/remediation results	<input checked="" type="checkbox"/>	<input type="checkbox"/>	<input type="checkbox"/>	<input type="checkbox"/>	14. ERRAP
<input checked="" type="checkbox"/>	<input type="checkbox"/>	<input type="checkbox"/>	<input type="checkbox"/>	7. Groundwater monitoring results	<input type="checkbox"/>	<input type="checkbox"/>	<input checked="" type="checkbox"/>	<input type="checkbox"/>	15. Other
<input checked="" type="checkbox"/>	<input type="checkbox"/>	<input type="checkbox"/>	<input type="checkbox"/>	8. Closure/Postclosure plans/results					

II. Operating Procedures:

Yes	No	N/A	PND	Item	Yes	No	N/A	PND	Item
<input checked="" type="checkbox"/>	<input type="checkbox"/>	<input type="checkbox"/>	<input type="checkbox"/>	1. All weather access road to facility	<input type="checkbox"/>	<input type="checkbox"/>	<input checked="" type="checkbox"/>	<input type="checkbox"/>	10. Scavenging and Salvaging
<input checked="" type="checkbox"/>	<input type="checkbox"/>	<input type="checkbox"/>	<input type="checkbox"/>	2. Controlled Access at facility	<input type="checkbox"/>	<input type="checkbox"/>	<input checked="" type="checkbox"/>	<input type="checkbox"/>	a. scavenging prohibited
<input checked="" type="checkbox"/>	<input type="checkbox"/>	<input type="checkbox"/>	<input type="checkbox"/>	a. fencing or other perimeter barriers	<input type="checkbox"/>	<input type="checkbox"/>	<input checked="" type="checkbox"/>	<input type="checkbox"/>	b. salvaging authorized
<input checked="" type="checkbox"/>	<input type="checkbox"/>	<input type="checkbox"/>	<input type="checkbox"/>	b. entrance gate with lock	<input type="checkbox"/>	<input type="checkbox"/>	<input checked="" type="checkbox"/>	<input type="checkbox"/>	c. salvaged material orderly
<input checked="" type="checkbox"/>	<input type="checkbox"/>	<input type="checkbox"/>	<input type="checkbox"/>	c. safe/proper on-site traffic patterns	<input type="checkbox"/>	<input type="checkbox"/>	<input checked="" type="checkbox"/>	<input type="checkbox"/>	d. salvage removal adequate
<input checked="" type="checkbox"/>	<input type="checkbox"/>	<input type="checkbox"/>	<input type="checkbox"/>	3. Signage	<input type="checkbox"/>	<input type="checkbox"/>	<input checked="" type="checkbox"/>	<input type="checkbox"/>	11. Animal feeding and grazing
<input checked="" type="checkbox"/>	<input type="checkbox"/>	<input type="checkbox"/>	<input type="checkbox"/>	a. facility name and permit number	<input checked="" type="checkbox"/>	<input type="checkbox"/>	<input type="checkbox"/>	<input type="checkbox"/>	a. animal feeding prohibited
<input checked="" type="checkbox"/>	<input type="checkbox"/>	<input type="checkbox"/>	<input type="checkbox"/>	b. days and hours of operation	<input type="checkbox"/>	<input type="checkbox"/>	<input checked="" type="checkbox"/>	<input type="checkbox"/>	b. grazing on final cover limited
<input checked="" type="checkbox"/>	<input type="checkbox"/>	<input type="checkbox"/>	<input type="checkbox"/>	c. wastes accepted/not accepted	<input checked="" type="checkbox"/>	<input type="checkbox"/>	<input type="checkbox"/>	<input type="checkbox"/>	12. Survey controls and monuments
<input checked="" type="checkbox"/>	<input type="checkbox"/>	<input type="checkbox"/>	<input type="checkbox"/>	d. telephone # of resp. official	<input checked="" type="checkbox"/>	<input type="checkbox"/>	<input type="checkbox"/>	<input type="checkbox"/>	a. facility and waste boundaries surveyed and marked
<input checked="" type="checkbox"/>	<input type="checkbox"/>	<input type="checkbox"/>	<input type="checkbox"/>	4. All weather access road in facility	<input checked="" type="checkbox"/>	<input type="checkbox"/>	<input type="checkbox"/>	<input type="checkbox"/>	b. survey monuments established
<input type="checkbox"/>	<input type="checkbox"/>	<input checked="" type="checkbox"/>	<input type="checkbox"/>	5. Adequate vehicle queuing	<input type="checkbox"/>	<input type="checkbox"/>	<input checked="" type="checkbox"/>	<input type="checkbox"/>	c. stakes clearly marked
<input type="checkbox"/>	<input type="checkbox"/>	<input checked="" type="checkbox"/>	<input type="checkbox"/>	6. Certified scale used	<input type="checkbox"/>	<input type="checkbox"/>	<input checked="" type="checkbox"/>	<input type="checkbox"/>	13. Fill Sequencing
<input type="checkbox"/>	<input type="checkbox"/>	<input checked="" type="checkbox"/>	<input type="checkbox"/>	7. Waste Screening	<input type="checkbox"/>	<input type="checkbox"/>	<input checked="" type="checkbox"/>	<input type="checkbox"/>	a. liner system protected
<input type="checkbox"/>	<input type="checkbox"/>	<input checked="" type="checkbox"/>	<input type="checkbox"/>	a. random inspections performed	<input type="checkbox"/>	<input type="checkbox"/>	<input checked="" type="checkbox"/>	<input type="checkbox"/>	b. slope failure controlled
<input type="checkbox"/>	<input type="checkbox"/>	<input checked="" type="checkbox"/>	<input type="checkbox"/>	b. inspection records	<input type="checkbox"/>	<input type="checkbox"/>	<input checked="" type="checkbox"/>	<input type="checkbox"/>	c. differential settlement controlled
<input type="checkbox"/>	<input type="checkbox"/>	<input checked="" type="checkbox"/>	<input type="checkbox"/>	c. trained personnel	<input type="checkbox"/>	<input type="checkbox"/>	<input checked="" type="checkbox"/>	<input type="checkbox"/>	d. run-on and runoff controlled
<input type="checkbox"/>	<input type="checkbox"/>	<input checked="" type="checkbox"/>	<input type="checkbox"/>	d. EPA notification procedures	<input type="checkbox"/>	<input type="checkbox"/>	<input checked="" type="checkbox"/>	<input type="checkbox"/>	14. Control of Workface
<input type="checkbox"/>	<input type="checkbox"/>	<input checked="" type="checkbox"/>	<input type="checkbox"/>	8. Prohibited materials listing	<input type="checkbox"/>	<input type="checkbox"/>	<input checked="" type="checkbox"/>	<input type="checkbox"/>	a. size of area controlled
<input type="checkbox"/>	<input type="checkbox"/>	<input checked="" type="checkbox"/>	<input type="checkbox"/>	9. Open Burning and Fire Hazards	<input type="checkbox"/>	<input type="checkbox"/>	<input checked="" type="checkbox"/>	<input type="checkbox"/>	b. slope is stable
<input checked="" type="checkbox"/>	<input type="checkbox"/>	<input type="checkbox"/>	<input type="checkbox"/>	a. open burning prohibited	<input type="checkbox"/>	<input type="checkbox"/>	<input checked="" type="checkbox"/>	<input type="checkbox"/>	c. litter control devices used
<input type="checkbox"/>	<input type="checkbox"/>	<input checked="" type="checkbox"/>	<input type="checkbox"/>	b. vehicle fueling prohibited within 50 feet of workface	<input type="checkbox"/>	<input type="checkbox"/>	<input checked="" type="checkbox"/>	<input type="checkbox"/>	d. vectors controlled
					<input type="checkbox"/>	<input type="checkbox"/>	<input checked="" type="checkbox"/>	<input type="checkbox"/>	e. operator at workface

<input type="checkbox"/>	<input type="checkbox"/>	<input checked="" type="checkbox"/>	<input type="checkbox"/>	15. Special Waste Handling	<input checked="" type="checkbox"/>	<input type="checkbox"/>	<input type="checkbox"/>	<input type="checkbox"/>	23. Run-on/Runoff Control Systems
<input type="checkbox"/>	<input type="checkbox"/>	<input checked="" type="checkbox"/>	<input type="checkbox"/>	a. operator familiar with SWAC	<input checked="" type="checkbox"/>	<input type="checkbox"/>	<input type="checkbox"/>	<input type="checkbox"/>	a. ponding controlled
<input type="checkbox"/>	<input type="checkbox"/>	<input checked="" type="checkbox"/>	<input type="checkbox"/>	16. Waste Fill Cover	<input checked="" type="checkbox"/>	<input type="checkbox"/>	<input type="checkbox"/>	<input type="checkbox"/>	b. dikes, ditches, berms & terraces intact
<input type="checkbox"/>	<input type="checkbox"/>	<input checked="" type="checkbox"/>	<input type="checkbox"/>	a. daily cover adequate	<input checked="" type="checkbox"/>	<input type="checkbox"/>	<input type="checkbox"/>	<input type="checkbox"/>	c. tile lines maintained
<input type="checkbox"/>	<input type="checkbox"/>	<input checked="" type="checkbox"/>	<input type="checkbox"/>	b. alternative cover authorized	<input type="checkbox"/>	<input type="checkbox"/>	<input checked="" type="checkbox"/>	<input type="checkbox"/>	24. Landfill Equipment
<input type="checkbox"/>	<input type="checkbox"/>	<input checked="" type="checkbox"/>	<input type="checkbox"/>	c. scarification of daily cover	<input type="checkbox"/>	<input type="checkbox"/>	<input checked="" type="checkbox"/>	<input type="checkbox"/>	a. working properly
<input type="checkbox"/>	<input type="checkbox"/>	<input checked="" type="checkbox"/>	<input type="checkbox"/>	d. intermediate cover adequate (30/180 day)	<input type="checkbox"/>	<input type="checkbox"/>	<input checked="" type="checkbox"/>	<input type="checkbox"/>	b. backup equipment available
<input checked="" type="checkbox"/>	<input type="checkbox"/>	<input type="checkbox"/>	<input type="checkbox"/>	e. final cover maintained	<input checked="" type="checkbox"/>	<input type="checkbox"/>	<input type="checkbox"/>	<input type="checkbox"/>	25. Groundwater Monitoring Wells
<input type="checkbox"/>	<input type="checkbox"/>	<input checked="" type="checkbox"/>	<input type="checkbox"/>	17. Leachate seeps	<input checked="" type="checkbox"/>	<input type="checkbox"/>	<input type="checkbox"/>	<input type="checkbox"/>	a. wells intact
<input type="checkbox"/>	<input type="checkbox"/>	<input checked="" type="checkbox"/>	<input type="checkbox"/>	a. seeps identified and controlled	<input checked="" type="checkbox"/>	<input type="checkbox"/>	<input type="checkbox"/>	<input type="checkbox"/>	b. caps and locks
<input type="checkbox"/>	<input type="checkbox"/>	<input checked="" type="checkbox"/>	<input type="checkbox"/>	18. Leachate recirculation	<input checked="" type="checkbox"/>	<input type="checkbox"/>	<input type="checkbox"/>	<input type="checkbox"/>	26. Gas Monitoring Wells/Points
<input type="checkbox"/>	<input type="checkbox"/>	<input checked="" type="checkbox"/>	<input type="checkbox"/>	a. composite liner	<input checked="" type="checkbox"/>	<input type="checkbox"/>	<input type="checkbox"/>	<input type="checkbox"/>	27. Emergency Procedures
<input type="checkbox"/>	<input type="checkbox"/>	<input checked="" type="checkbox"/>	<input type="checkbox"/>	b. RD&D authorization	<input checked="" type="checkbox"/>	<input type="checkbox"/>	<input type="checkbox"/>	<input type="checkbox"/>	a. ERRAP available to staff
<input type="checkbox"/>	<input type="checkbox"/>	<input checked="" type="checkbox"/>	<input type="checkbox"/>	c. personnel protected	<input checked="" type="checkbox"/>	<input type="checkbox"/>	<input type="checkbox"/>	<input type="checkbox"/>	b. emergency numbers posted
<input type="checkbox"/>	<input type="checkbox"/>	<input checked="" type="checkbox"/>	<input type="checkbox"/>	d. erosion controlled	<input checked="" type="checkbox"/>	<input type="checkbox"/>	<input type="checkbox"/>	<input type="checkbox"/>	28. Final Cover System
<input type="checkbox"/>	<input type="checkbox"/>	<input checked="" type="checkbox"/>	<input type="checkbox"/>	e. vegetation maintained	<input checked="" type="checkbox"/>	<input type="checkbox"/>	<input type="checkbox"/>	<input type="checkbox"/>	a. final cover over completed areas
<input type="checkbox"/>	<input type="checkbox"/>	<input checked="" type="checkbox"/>	<input type="checkbox"/>	19. Site Litter Control	<input checked="" type="checkbox"/>	<input type="checkbox"/>	<input type="checkbox"/>	<input type="checkbox"/>	b. seeded
<input type="checkbox"/>	<input type="checkbox"/>	<input checked="" type="checkbox"/>	<input type="checkbox"/>	a. on-site litter picked up daily	<input type="checkbox"/>	<input checked="" type="checkbox"/>	<input type="checkbox"/>	<input checked="" type="checkbox"/>	c. vegetation established
<input type="checkbox"/>	<input type="checkbox"/>	<input checked="" type="checkbox"/>	<input type="checkbox"/>	b. offsite litter picked up daily	<input checked="" type="checkbox"/>	<input type="checkbox"/>	<input type="checkbox"/>	<input type="checkbox"/>	d. run-on, runoff, and ponding controlled
<input type="checkbox"/>	<input type="checkbox"/>	<input checked="" type="checkbox"/>	<input type="checkbox"/>	c. record of why litter not picked up	<input checked="" type="checkbox"/>	<input type="checkbox"/>	<input type="checkbox"/>	<input type="checkbox"/>	e. differential settlement controlled
<input type="checkbox"/>	<input type="checkbox"/>	<input checked="" type="checkbox"/>	<input type="checkbox"/>	20. Dust Control	<input type="checkbox"/>	<input type="checkbox"/>	<input checked="" type="checkbox"/>	<input type="checkbox"/>	29. Other
<input type="checkbox"/>	<input type="checkbox"/>	<input checked="" type="checkbox"/>	<input type="checkbox"/>	a. dust controlled as vehicles enter/exit facility					
<input type="checkbox"/>	<input type="checkbox"/>	<input checked="" type="checkbox"/>	<input type="checkbox"/>	b. dust controlled on internal roads					
<input type="checkbox"/>	<input type="checkbox"/>	<input checked="" type="checkbox"/>	<input type="checkbox"/>	c. dust controlled at the workplace					
<input type="checkbox"/>	<input type="checkbox"/>	<input checked="" type="checkbox"/>	<input type="checkbox"/>	21. Mud Control					
<input type="checkbox"/>	<input type="checkbox"/>	<input checked="" type="checkbox"/>	<input type="checkbox"/>	a. mud controlled as vehicles enter/exit facility					
<input checked="" type="checkbox"/>	<input type="checkbox"/>	<input type="checkbox"/>	<input type="checkbox"/>	22. Leachate Control and Treatment					
<input checked="" type="checkbox"/>	<input type="checkbox"/>	<input type="checkbox"/>	<input type="checkbox"/>	a. system operational					
<input checked="" type="checkbox"/>	<input type="checkbox"/>	<input type="checkbox"/>	<input type="checkbox"/>	b. head measurement device					
<input type="checkbox"/>	<input type="checkbox"/>	<input checked="" type="checkbox"/>	<input type="checkbox"/>	c. seeps controlled					
<input type="checkbox"/>	<input type="checkbox"/>	<input checked="" type="checkbox"/>	<input type="checkbox"/>	d. leachate tank maintained					
<input checked="" type="checkbox"/>	<input type="checkbox"/>	<input type="checkbox"/>	<input type="checkbox"/>	e. leachate lagoon maintained					
<input checked="" type="checkbox"/>	<input type="checkbox"/>	<input type="checkbox"/>	<input type="checkbox"/>	f. POTW agreement					
<input type="checkbox"/>	<input type="checkbox"/>	<input checked="" type="checkbox"/>	<input type="checkbox"/>	g. sanitary sewer discharge					
<input type="checkbox"/>	<input type="checkbox"/>	<input checked="" type="checkbox"/>	<input type="checkbox"/>	h. NPDES discharge permit					
<input type="checkbox"/>	<input type="checkbox"/>	<input checked="" type="checkbox"/>	<input type="checkbox"/>	i. NPDES on-site treatment					
Comments: See the cover letter within this submittal for additional recommendations and information.									
AUTHENTICATION									
INSPECTOR	Aaron Brewer							Date: 05/13/2025	
REVIEWER	Katie Kinley, PE								

General Description:

I. Record Keeping:

1. Permit application, permit renewal and permit modifications application materials pursuant to rule 113.5(455B). [See 113.11 (1)“a”]:
2. The site exploration and characterization reports pursuant to subrule 113.6(4). [See 113.11 (1)“b”]:
3. Design and construction plans and specifications, and related analyses and documents, pursuant to rule 113.7(455B). The QC&A final reports, and related analyses and documents, pursuant to paragraph 113.7(6)“d”. [See 113.11 (1)“c”]:
4. Inspection records, training procedures, and notification procedures required in rule 113.8(455B). [See 113.11 (1)“d”]:
5. Any MSWLF unit design documentation for placement of leachate or gas condensate in an MSWLF unit as required under numbered paragraphs 113.8(1)“b”(3)“2” and “3”. [See 113.11 (1)“e”]:
6. Gas monitoring results from monitoring and any remediation plans required by rule 113.9(455B). [See 113.11 (1)“f”]:
7. Any demonstration, certification, finding, monitoring, testing, or analytical data required by rule 113.10(455B). [See 113.11 (1)“g”]:
8. Closure and postclosure care plans and any monitoring, testing, or analytical data as required by rules 113.12(455B) and 113.13(455B). [See 113.11 (1)“h”]:
9. Any cost estimates and financial assurance documentation required by this chapter. [See 113.11 (1)“i” and 113.8(3)“j”]:
10. Stormwater permit [See 64.3(455B)]:
11. Special Waste Authorizations and Special Waste Acceptance Criteria [See 109(455B)]:
12. Operator certifications [See 113.8(6)]:
13. DOPs [See 113.8(455B)]:
14. ERRAP [See 113.8(5)]:
15. Other:

II. Operating Procedures:

1. All-weather access roads to the facility [See 113.7(3) “a”]:
2. Controlled access into and within site [See 113.8(3) “a”]:
 - Including a perimeter fence with a lockable gate(s) to help prevent unauthorized access [See 113.7(3) “b”]:
 - Including signs or pavement markings clearly indicating safe and proper on-site traffic patterns. [See 113.7(3) “e”]:
3. A sign at the entrance to the facility specifying: [See 113.7(3) “c”]:
 - (1) Name and permit number of the facility:
 - (2) Days and hours that the facility is open to the public or a statement that the facility is not open to the public:
 - (3) A general list of materials that are not accepted:
 - (4) Telephone number of the official responsible for operation of the facility and the emergency contact person(s):
4. All-weather access roads within the facility. [See 113.7(3) “d” and 113.8(3)“c”]:
5. Adequate queuing distance for vehicles entering and exiting the property. [See 113.7(3) “f”]:
6. A scale certified by the Iowa department of agriculture and land stewardship. [See 113.7(3) “g” and 113.8(3)“b”]:
7. Waste screening for prohibited materials [See 113.8(1) “a”]:
 - (1) Random inspections of incoming load:
 - (2) Records of any inspections:
 - (3) Training of personnel to recognize prohibited wastes:

(4) Notification to EPA for hazardous wastes:

8. Prohibited materials list [See 113.8(1) "b"]:
9. Open burning and fire hazards [See 113.8(1) "c"]:
10. Scavenging and salvaging [See 113.8(1) "d" and 113.8(3)"d"]:
11. Animal feeding and grazing [See 113.8(1) "e"]:
12. Survey controls and monuments [See 113.8(2) "a"]:
13. Fill sequencing [See 113.8(2) "c"]:
14. Working face controlled [See 113.8(2) "d"]:
15. Special Wastes Managed [See 113.8(2) "e"]:
16. Cover/Alternative cover material adequate [See 113.8(2) "f"]:
17. Leachate seeps controlled [See 113.8(2) "g"]:
18. Leachate Recirculation in composite cell or with RD&D permit [See 113.8(2) "h"]:
19. Litter control [See 113.8(3) "f"]:
20. Dust control [See 113.8(3) "g"]:
21. Mud control [See 113.8(3) "h"]:
22. Leachate collection [See 113.7(5)"b"] and treatment [See 113.8(3) "i"]:
23. Run-on and Runoff Control Systems [See 113.7(8)]:
24. Equipment for disposal operations [See 113.8(455B)]:
25. Groundwater monitoring wells [See 113.10(2)]:
26. Gas monitoring wells/probes [See 113.9(2)]:
27. Emergency procedures available to staff [See 113.8(5)]:
28. Final cover system control [See 113.12(455B)]:
29. Other:

SUMMARY OF REQUIREMENTS

SUMMARY OF REMINDERS

SUMMARY OF RECOMMENDATIONS