



February 25, 2022

City of Washington, IA
215 East Washington Street
Washington, IA 52353

Interstate Power and Light Company
B&V Project 411266
B&V File 14.5300

Attention: Brent Hinson, City Administrator

Subject: Washington Former Manufactured Gas Plant Site

As you may be aware, there is an ongoing environmental investigation associated with the former manufactured gas plant (MGP) site at 220 East 3rd Street in Washington. This property is owned by Interstate Power and Light Company (IPL), an Alliant Energy company, and historically housed a facility that manufactured gas for heating and lighting before natural gas was available. The work is being conducted under a Consent Order with the Iowa Department of Natural Resources (IDNR). IPL and Black & Veatch would like to thank you for your cooperation in allowing us access to the city right-of-way near the site. Your continued cooperation has assisted us greatly in site investigation activities.

In 2021, no site work was conducted. Although no specific site activities are anticipated for 2022, monitoring wells will remain in place as required by IDNR.

A figure is attached to show the site area and the locations of monitoring wells that are integral to site evaluation. We request that your city crews be aware of well locations during utility and roadway maintenance and snow removal activities. Because it is costly to repair or replace damaged or buried wells, any assistance that you can provide to prevent such occurrences is greatly appreciated. This includes taking additional care when operating heavy equipment around each well during activities that could damage the surface completion or monitoring well. Please contact me if any action is planned in these areas that could impact a well. We will be glad to work with the city to protect, modify, or abandon and replace any affected monitoring well.

If you have any questions regarding this letter or the work completed to date at the site, please do not hesitate to contact me at (913) 458-6547.

Very truly yours,

Black & Veatch Corporation

Barbara A. Butler, P.E.
Project Manager

cc: Jill Stevens/Jessica Wilkening, Alliant Energy
Hylton Jackson, IDNR

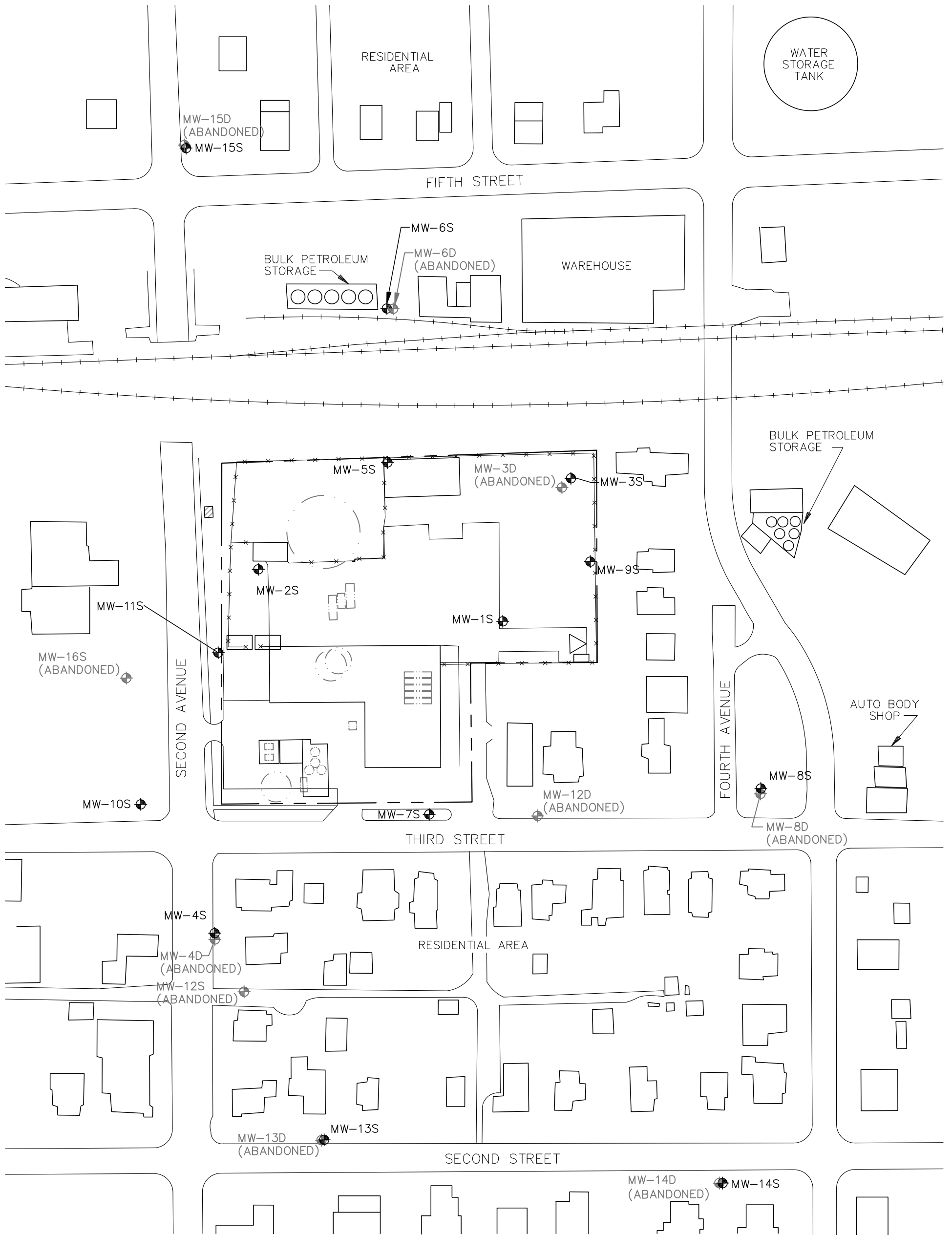

LEGEND

- MONITORING WELL
- FENCE
- RAILROAD
- FORMER STRUCTURES
- IPL PROPERTY BOUNDARY
- ABANDONED MONITORING WELL



BASE DRAWING SOURCES:
 ISU 1989
 SCHEMMER 1994
 WASHINGTON 1993



FIGURE 1
 SHALLOW GROUNDWATER
 POTENTIOMETRIC SURFACE CONTOURS
 WASHINGTON MGP SITE
 PW: WASHINGTON-175776/AutoCAD Drawings/2012/Figure 1.dwg