



BLACK & VEATCH

Black & Veatch Corporation

11401 Lamar Avenue, Overland Park, KS 66211 USA

P +1 913 458-6547 E ButlerBA@bv.com

February 25, 2022

City of Marshalltown
24 North Center Street
Marshalltown, IA 50158

Interstate Power and Light Company
B&V Project 411262
B&V File 14.5300

Attention: Jessica Kinser, City Administrator

Subject: Marshalltown Former Manufactured Gas Plant Site

As you may be aware, there is an ongoing environmental investigation associated with the former manufactured gas plant (MGP) site located at Nevada and South 7th Streets. This property is owned by Interstate Power and Light Company (IPL), an Alliant Energy company, and historically housed a facility that manufactured gas for heating and lighting before natural gas was available. The work is being conducted under a Consent Order with the Iowa Department of Natural Resources (IDNR). IPL and Black & Veatch would like to thank you for your cooperation in allowing us access to the city right-of-way near the site. Your continued cooperation has assisted us greatly in site investigation activities.

In 2021, quarterly measurement/recovery of MGP-related residuals in selected wells was conducted. Quarterly measurement/recovery of MGP-related residuals in selected wells will continue in 2022.

A figure is attached that shows the site area and the locations of monitoring wells that are integral to site evaluation. We request that your city crews be aware of well locations during utility and roadway maintenance and snow removal activities. Because it is costly to repair or replace damaged or buried wells, any assistance that you can provide to prevent such occurrences is greatly appreciated. This includes taking additional care when operating heavy equipment around each well during activities that could damage the surface completion or well. Please contact me if any action is planned in these areas that could impact a well. We will be glad to work with the city to protect, modify, or abandon and replace any affected well.

If you have any questions regarding this letter or the work completed to date at the site, please do not hesitate to contact me at (913) 458-6547.

Very truly yours,

Black & Veatch Corporation

Barbara A. Butler, P.E.
Project Manager

cc: Jill Stevens/Jessica Wilkening, Alliant Energy
Hylton Jackson, IDNR

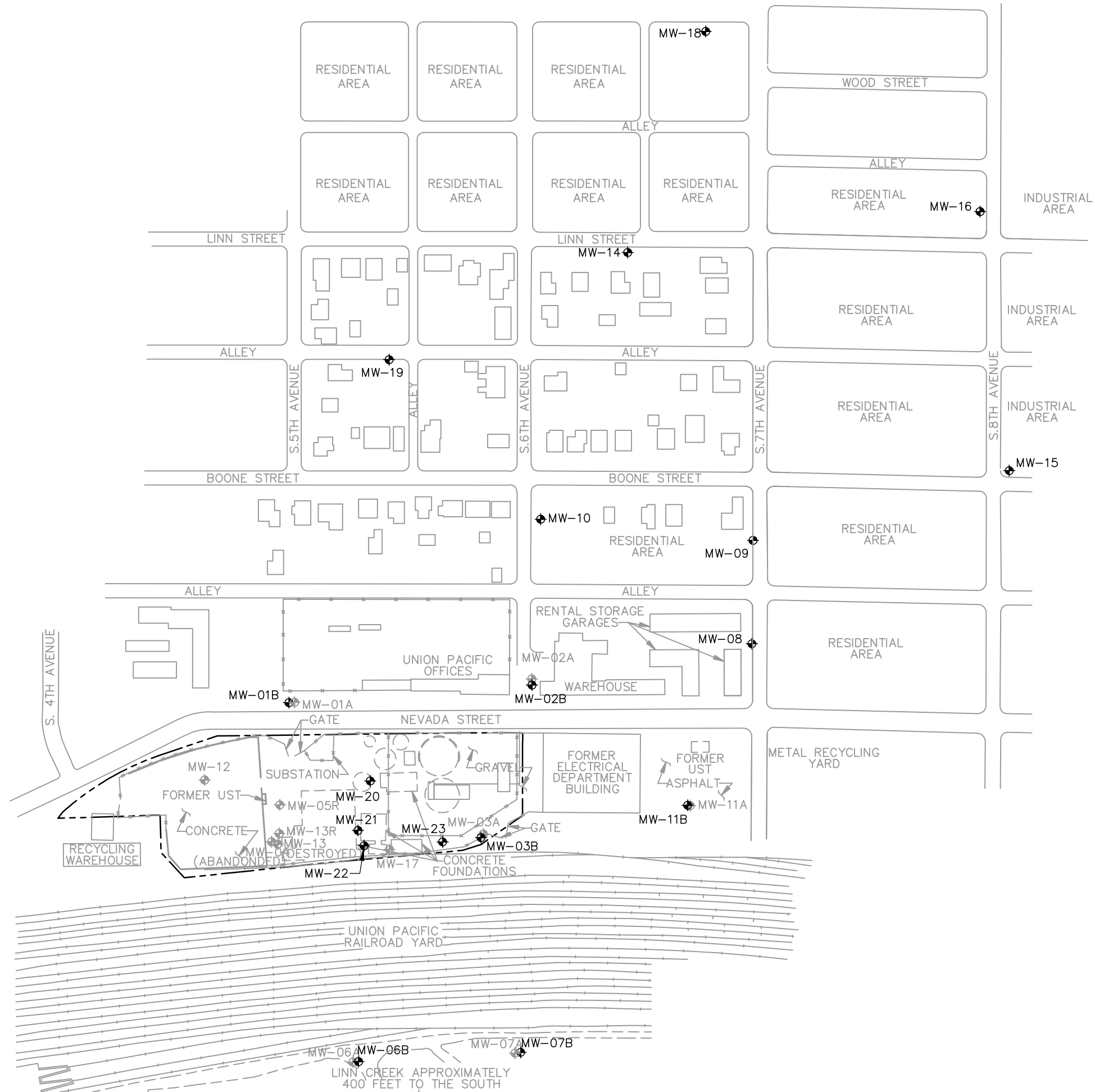

LEGEND

- MW-2B
MONITORING WELL
- APPROXIMATE IPL
PROPERTY BOUNDARY
- FENCE
- UNION PACIFIC RAILROAD
- []
EXISTING STRUCTURES
- []
FORMER OR BELOW
GRADE STRUCTURES



FIGURE 1
SITE MAP
MARSHALLTOWN MGP SITE
PW: ...\\MARSHALLTOWN\\40.0000\\47.0000\\2017