

Last review: Diana Engeman, June 19,2020

## 1.0 REGION 7, E.I. DUPONT DE NEMOURS & CO. (COUNTY ROAD X-23) SITE STRATEGY: VERSION 1 OVERVIEW

### 1.1 BRIEF DESCRIPTION OF SITE

The Du Pont County Road X-23 site in Lee County, Iowa, consists of two subsites, known as the Baier and McCarl subsites. The remedy for the site included stabilization and solidification of contaminated soil from both subsites into a solid monolith which was covered with a soil cap at the Baier subsite. The remedy also included groundwater monitoring and the implementation of covenants and deed notices restricting the future use of the subsites. There is an environmental covenant on the Baier subsite but the restrictions were removed from the McCarl subsite since all waste was removed and taken to the Baier subsite. There is no groundwater plume. Groundwater is only monitored to monitor condition of the monolith. Figure 1 shows the approximate location of the two subsites. Figure 2 shows the Baier subsite.

### 1.2 SITE STRATEGY EXECUTIVE SUMMARY AND STATUS OF OPERABLE UNITS

*Narrative description of the overall site strategy*

Designation of operable units and current status

| <u>Operable Unit</u> |                  | <u>Status</u>                     |             |                            |                       |                     |
|----------------------|------------------|-----------------------------------|-------------|----------------------------|-----------------------|---------------------|
| <u>Number/Title</u>  | <u>Rationale</u> | <u>Phase of Superfund Process</u> | <u>Lead</u> | <u>Acquisition Vehicle</u> | <u>Next Milestone</u> | <u>Planned date</u> |
| 01                   | Entire site      | Deleted                           | PRP         | None                       | FYR completion        | 5/12/22             |

## 2.0 SITE STRATEGY FRAMEWORK

### 2.1 SITE GOALS

- All site cleanup goals have been met.
- The property owner (Corteva) will not consider redevelopment of the subsites and since they are in rural areas, and redevelopment opportunities would be virtually non-existent.
- There are no technical issues with the site.
- The community has shown no interest in this site in >20 years.

## 2.2 KEY ISSUES/CHALLENGES

| <u>Issue Category</u> | <u>Issue Description</u> | <u>Impact to Site (scope, schedule, budget)</u> | <u>Plan for Resolution (mitigate, monitor, elevate, etc.)</u> | <u>Planned Completion Date</u> |
|-----------------------|--------------------------|---|---|--------------------------------|
| Choose an item.       | None                     |   |   |                                |

## 2.3 PRIORITIZATION OF SITE GOALS

### Near-Term Priorities (Next five to ten years)

- *[Goal and rationale for near term prioritization]. [Enter narrative description of those CERCLA remedial and enforcement activities that are needed to achieve the goal.]*
- *[Goal and rationale for near term prioritization]. [Enter narrative description of those CERCLA remedial and enforcement activities that are needed to achieve the goal]*
- *[Goal and rationale for near term prioritization]. [Enter narrative description of those CERCLA remedial and enforcement activities that are needed to achieve the goal]*

### Longer-Term Priorities

- *[Goal and rationale for longer term prioritization]. [Enter narrative description of those CERCLA remedial and enforcement activities that are needed to achieve the goal]*
- *[Goal and rationale for long term prioritization]. [Enter narrative description of those CERCLA remedial and enforcement activities that are needed to achieve the goal]*

### Does SEMS Planning Data Support Site Strategy Framework?

Yes     No

## 3.0 VERSION/UPDATE LOG

| <b>Version</b> | <b>Date Updated</b> | <b>Summary of Key Changes</b> |
|----------------|---------------------|-------------------------------|
|                |                     |                               |
|                |                     |                               |
|                |                     |                               |

Attachments: Site Maps and Figures and Site Information

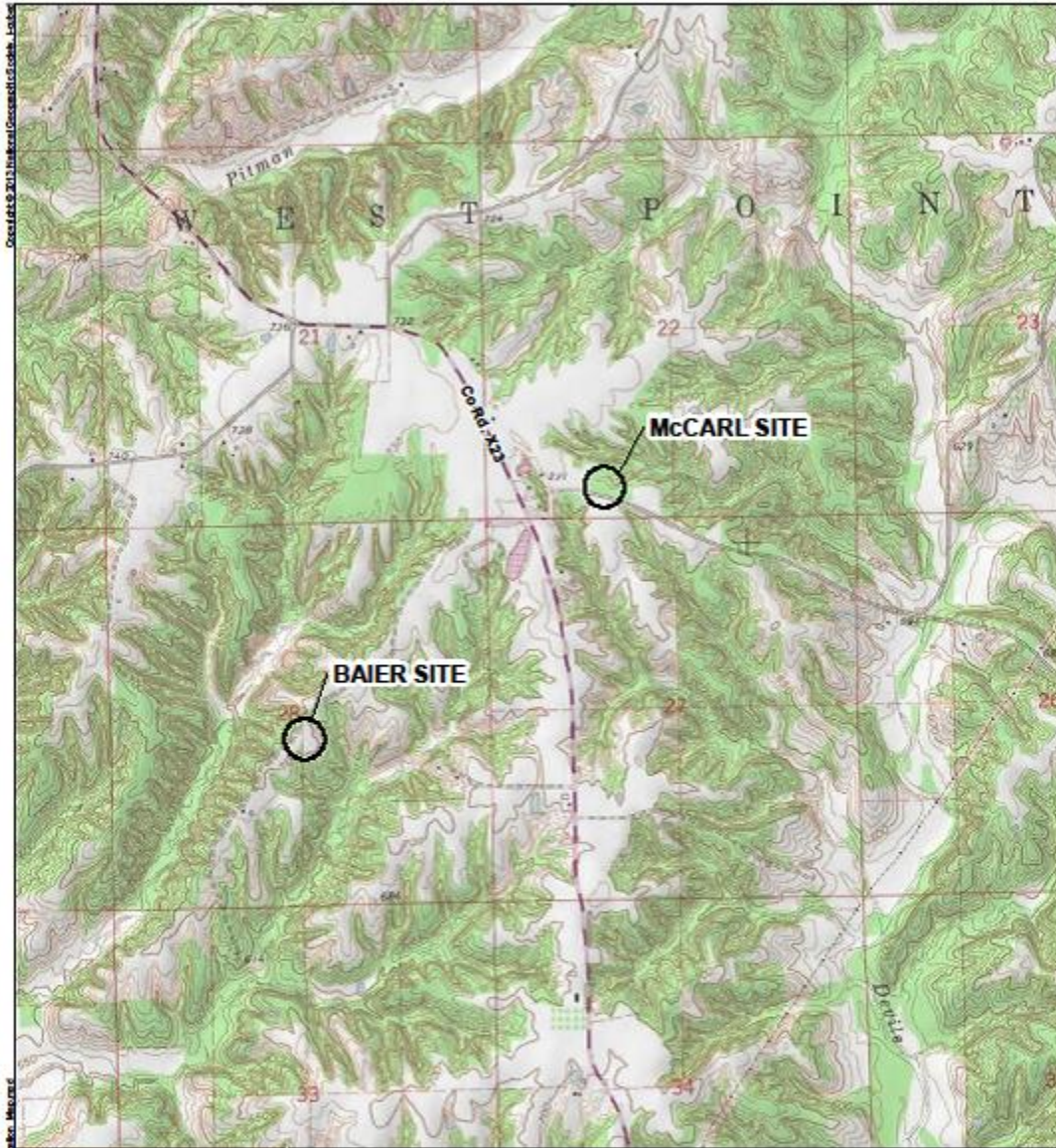

**AECOM**

AECOM  
Sabre Building, Suite 300  
4051 Oglethorpe Road  
Newark, DE 19713



0 1,000 2,000  
Feet

1 inch = 2,000 feet  
MAP FORMATTED FOR "A" (11" X 17") SIZE SHEET.  
TEXT SCALE NOT VALID FOR DIFFERENT PAGE SIZE.

**SITE LOCATION MAP**

DUPONT BAIER SITE  
COUNTY ROAD X23  
LEE COUNTY, IOWA

|                        |             |                 |           |
|------------------------|-------------|-----------------|-----------|
| TASK NUMBER:           | 18003       | PROJECT NUMBER: | 60487500  |
| DESIGNED BY:           | M.LAYTON    | DATE:           | 12/9/2016 |
| DRAWN BY:              | M.LAYTON    | FIGURE NUMBER:  | 1         |
| DATA QUALITY CHECK BY: | T.LOUNSBURY |                 |           |

U:\Bent-NCCart\Lee\DWG\89C7563\89C7563.dwg, 2/21/2012 2:23:48 PM, DWG TO PDF.pc3

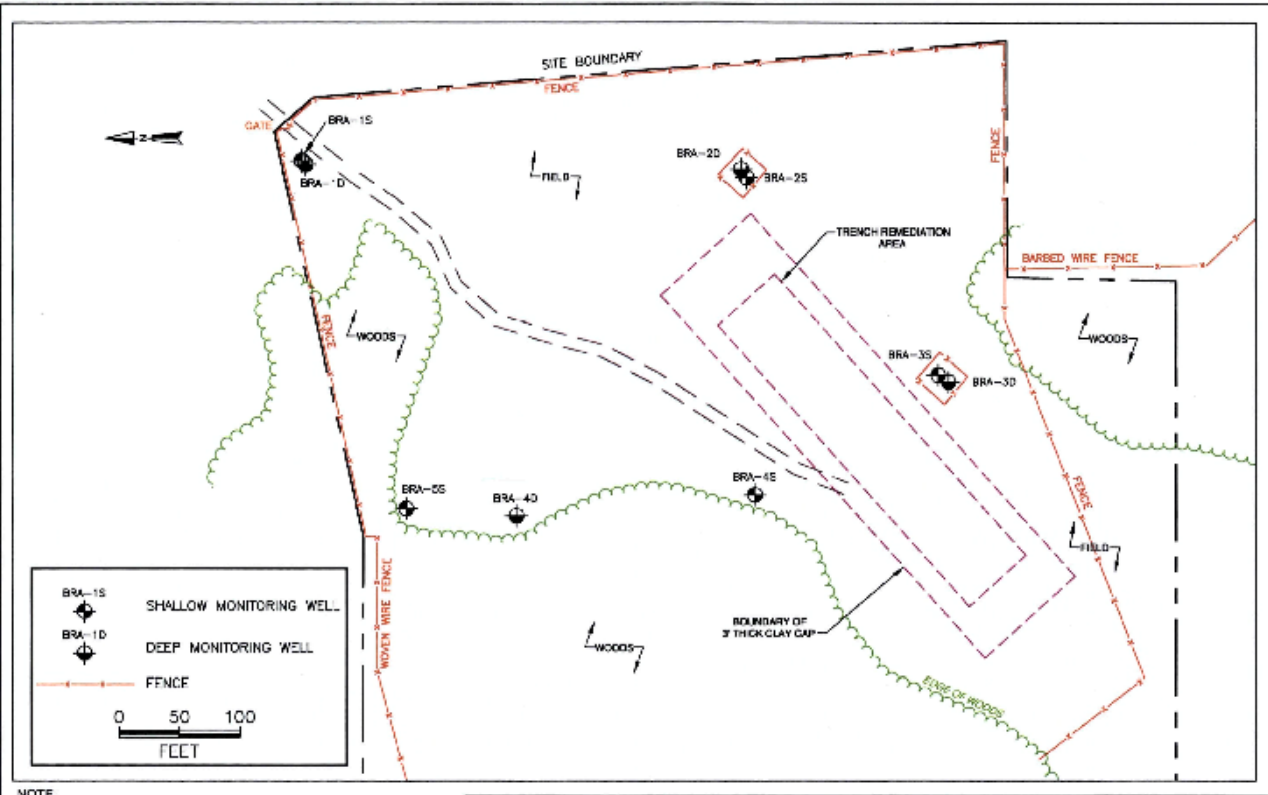

**NOTE.**

REMEDIATION AREA LOCATION FROM DRAWING #82200-2 SHEET 2 OF 3, DATED 8/22/93 BY REGISTERED LAND SURVEYOR (STATE OF IOWA), MR. DAVID R. WOLFE, AS SHOWN ON WOODWARD-GLYDE DRAWING 4-2, PROJECT NUMBER 89C7563-2.

DESIGNED BY:  
**M. BRILL**  
DRAWN BY:  
**D. LITTEL**  
QA/QA QUALITY CHECK:  
**M. BRILL**  
APPROVED BY:

**URS**  
URS Corporation  
Iron Hill Corporate Center  
4051 Ogletown Road, Suite 300  
Newark, Delaware 19713  
Phone: 302-781-5900  
Fax: 302-781-5601

**MONITORING WELL AND  
REMEDIATION AREA  
LOCATION MAP**  
**DUPONT BAIER SITE  
COUNTY ROAD X23  
LEE COUNTY, IOWA**

PROJECT NO:  
**18986224**  
DATE:  
**2/15/12**  
FIGURE NO:  
**2**

**Site Identification**

Site Name: E.I. duPont de Nemours & Co.

Alias Names: County Road X-23, McCarl Farm, Baier Farm

EPA ID: IAD980685804

SSID; 07Y6

Region: 7

State: Iowa

City/County: West Point/Lee

**Site Location**

Address N/A

City, State West Point, Iowa

**Operable Units Description**

OU1 – Entire site

**Lead:**

PRP Lead Corteva Agriscience™ – Agriculture Division of DowDupont

**Site Team**

| Title                      | Name                    | Contact Phone Number |
|----------------------------|-------------------------|----------------------|
| RPM                        | Diana Engeman           | x7746                |
| State PM                   | Matt Culp               | 515-725-8337         |
| Counsel                    | Dave Hoefler            | x7503                |
| Hydrogeologist             | Randy Brown             | x7978                |
| Human Health Risk Assessor | Todd Phillips           | x7438                |
| Ecological Risk Assessor   | Catherine Wooster-Brown | x7425                |

**Site Description**

The Du Pont County Road X-23 site in Lee County, Iowa, consists of two subsites, known as the Baier and McCarl subsites. The remedy for the site included stabilization and solidification of contaminated soil from both subsites into a solid monolith which was covered with a soil cap at the Baier subsite. The remedy also included groundwater monitoring and the implementation of covenants and deed notices restricting the future use of the subsites. There is an environmental covenant on the Baier subsite but the restrictions were removed from the McCarl subsite since all waste was removed and taken to the Baier subsite. There is no groundwater plume. Groundwater is only monitored to monitor condition of the monolith. Figure 1 shows the approximate location of the two subsites. Figure 2 shows the Baier subsite.

The contaminants of concern (COCs) identified in soil at the Baier and McCarl subsites were:

| <u>Inorganic Contaminants</u> | <u>Volatile Organic Contaminants</u> | <u>Semi-volatile Contaminants</u> |
|-------------------------------|--------------------------------------|-----------------------------------|
| Arsenic                       | Ethylbenzene                         | Bis(2-ethylhexyl)phthalate        |
| Barium*                       | 4-methyl-2-pentanone                 | 2-methyl naphthalene              |
| Cadmium                       | Toluene                              | Naphthalene                       |
| Chromium                      | 1,1,1 -trichloroethane**             |                                   |
| Copper*                       | Xylenes                              |                                   |
| Lead                          |                                      |                                   |
| Manganese*                    |                                      |                                   |
| Selenium                      |                                      |                                   |
| Zinc                          |                                      |                                   |

\* Contaminant found at the McCarl subsite only.

\*\* Contaminant found at the Baier subsite only.

The site was listed on the NPL 8/30/1990 and deleted on 9/25/1995.

### **Current Site Conditions**

Both subsites are inspected twice a year. Fencing is maintained and if any damage to the cap at the Baier subsite is found it is repaired. The cap is mowed annually. Groundwater is sampled every third year.

| <b>Chronology of Selected Site Events</b> |             |
|---|-------------|
| <b>Event</b>                              | <b>Date</b> |
| Record of Decision (ROD) signed           | 5/28/1991   |
| Consent Decree for RD/RA finalized        | 4/23/1992   |
| ESD signed                                | 5/11/1992   |
| Remedial design completed                 | 6/5/1992    |
| Preliminary Close Out Report signed       | 9/29/1993   |
| Final Close-out Report                    | 8/1/1994    |
| Deletion from NPL                         | 9/25/1995   |
| First five-year review                    | 6/19/1997   |
| Second five-year review                   | 8/16/2002   |
| Third five-year review                    | 8/15/2007   |
| Fourth five-year review                   | 6/26/2012   |
| Fifth five-year review                    | 5/12/2017   |

### **Upcoming Schedule and Targets**

FYR start 5/12/2021

FYR completion 5/12/2022

## **Issues**

This site has been identified as one with a high likelihood of the presence of PFAs. The wastes disposed were from the production of automotive paints. Corteva has provided information that they believe shows they did not use these compounds. Waste disposal ceased at the site in November 1953, early in the use of PFAS. Further evaluation of groundwater at the site by our hydrogeologist is needed before we move forward with PFAS sampling. The ROD is “no action” for groundwater.

## **GPRA Measures**

### **Human Exposure Under Control**

Long-term Human Health Protection Achieved 9/23/2005 which is a higher level than HEUC.

### **Groundwater Migration Under Control**

Site has achieved GMUC but no date given. Site was GMUC before EIs existed so probably went in at initiation of the measure.

### **Remedial Action Complete**

3/2/1994

### **Construction Complete**

9/10/1993

### **Site-wide Ready for Anticipated Use**

6/26/2006

## **Resource/Funding**

None

## **Community/Congressional/Outside Interests**

No interest. The site is a field in the middle of a field, accessed through a farmer’s pasture. No one even knows this site exists.