



BLACK & VEATCH
Building a **world** of difference.

Interstate Power and Light Company
Carroll MGP Site

B&V Project 172417.1000
B&V File A04E
March 4, 2011

Mr. Gerald Clausen
City Administrator
112 East 5th Street
Carroll, IA 51401

Subject: Status of Work in City Right-of-Way

Dear Mr. Clausen:

As you are aware, there is an ongoing environmental investigation associated with the former manufactured gas plant (MGP) site at 317 North Clark Street. This property is owned by Interstate Power and Light Company (IPL), an Alliant Energy company, and historically housed a facility that manufactured gas for heating and lighting before natural gas was available. The work at this site is being conducted under a Consent Order with the Iowa Department of Natural Resources (IDNR). IPL and Black & Veatch would like to thank you for your cooperation in allowing us access to the city right-of-way property near the site. Your continued cooperation has assisted us greatly in site investigations.

Over the last year, we collected ground water samples from wells MW-2A, MW-4, MW-5, and MW-9 in the city right-of-way. MGP-related chemicals were detected in wells MW-4, MW-5, and MW-9, but concentrations were less than the IDNR ground water compliance standards.

A figure is attached to show the site area and the locations of monitoring wells that are integral to site evaluation. We request that your city crews be aware of well locations during utility and roadway maintenance activities and snow removal. Because it is costly to repair or replace damaged or buried wells, any assistance that you can provide to prevent such occurrences is greatly appreciated. This includes taking additional care when operating heavy equipment around each well during activities that could damage the surface completion or monitoring well. Please contact me if any action is planned in these areas that could impact a well. We will be glad to work with the city to protect, modify, or abandon and replace any affected monitoring well.

If you have any questions regarding this letter or the work completed to date at the site, please do not hesitate to contact me at (913) 458-6547.

Very truly yours,

BLACK & VEATCH

Barbara A. Butler
Project Manager

Enclosure

cc: Jill Stevens, Alliant Energy
Greg Fuhrman, IDNR
File

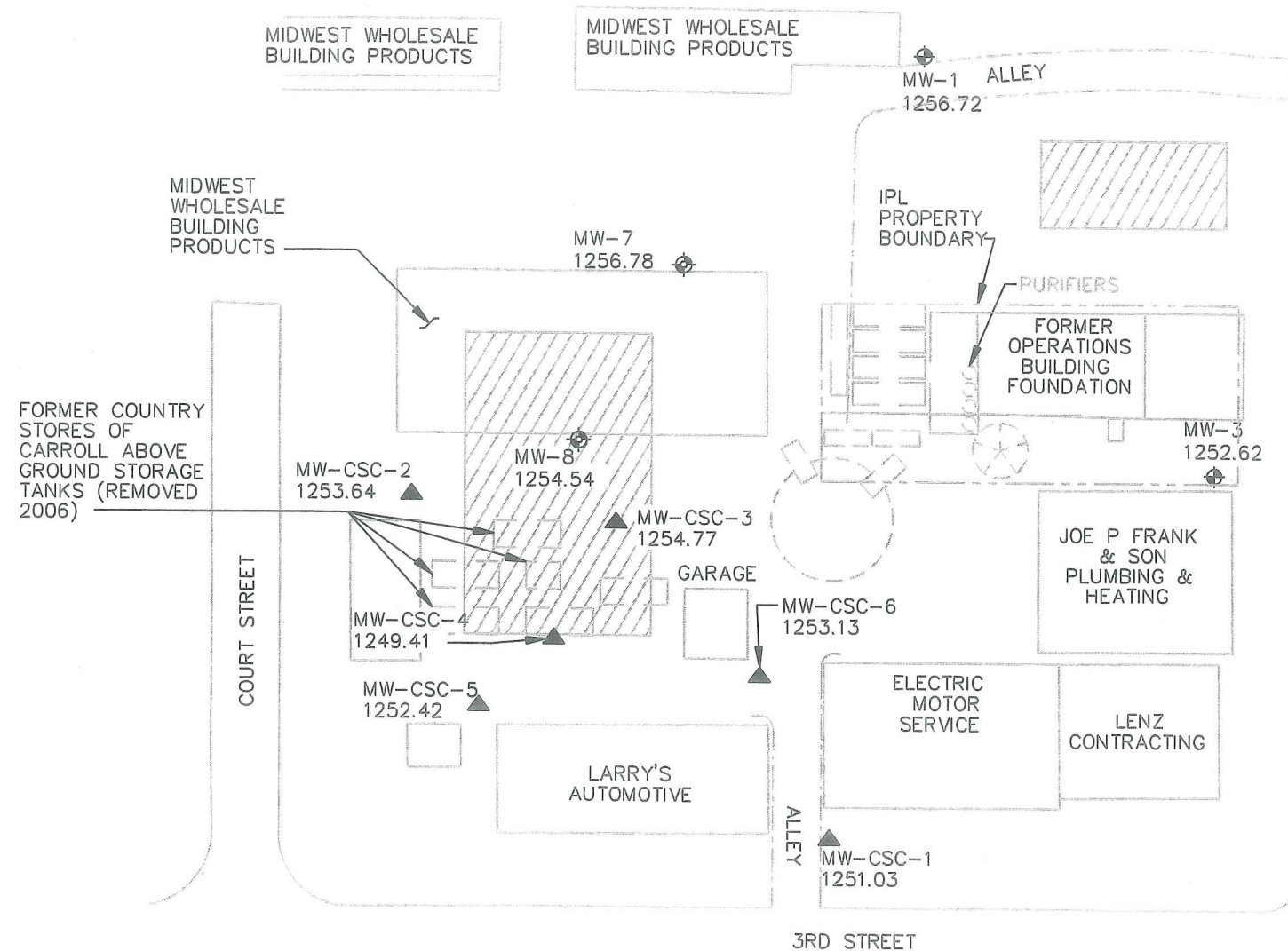

LEGEND

- EXISTING STRUCTURE
- BELOW GRADE STRUCTURE (ACTUAL LOCATIONS REVEALED DURING EXCAVATION)
- FORMER ABOVE GRADE STRUCTURE
- IPL PROPERTY BOUNDARY
- MONITORING WELL
- PREPACKED SCREEN MONITORING WELL
- COUNTRY STORES OF CARROLL MONITORING WELL
- ABANDONED MONITORING WELL
- APPROXIMATE AREA OF HISTORICAL ABOVE GROUND STORAGE TANKS/SUPPORT FACILITIES (CIRCA 1930's)

NOTES

1. MONITORING WELL MW-2 WAS ABANDONED IN APRIL 2001, AND WAS REPLACED WITH WELL MW-2A.
2. THE ABOVE GROUND STORAGE TANKS IDENTIFIED SOUTHWEST OF WELL MW-8 WERE REMOVED IN LATE 2004 EARLY 2005.
3. COUNTRY STORES OF CARROLL MONITORING WELLS WERE INSTALLED IN SEPTEMBER 2006 AS PART OF A SITE ASSESSMENT FOR THE FORMER BULK STORAGE FACILITY LOCATED AT 310 N. COURT ST.

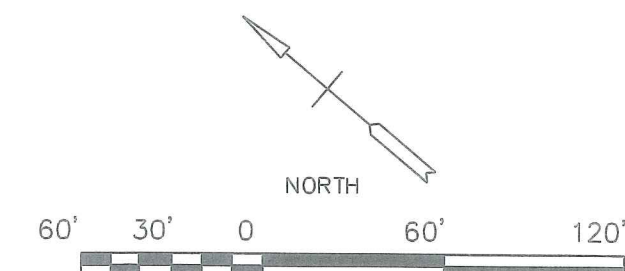

SOURCES: EDS 2002, TINKHAM 1995, 1998, 2001
IOWA RAILWAY & LIGHT CO. 1929

MW-6
1255.78

FIGURE 1
MONITORING WELL LOCATIONS
CARROLL MGP SITE
T0000V085