

Site Name: Kline Oil Company, Knoxville

Pre-Remedial Initial Site Screening (ISS)

Project Manager: Tami S. Rice

Date: February 27, 2007

Summarize the site history (past usages, past ownerships, wastes, known or suspected contamination pathways such as tanks, septic tank/tile field, lagoon, land applications, S.W. burial, etc)

The site consists of about 4,000 square feet which is owned by Burlington Northern Santa Fe (BNSF) Railway Company and was leased to Kline Oil Company for use as a bulk oil storage and transfer facility. Petroleum products were stored in aboveground storage tanks (ASTs).

The surrounding area consists of a recycling/storage facility to the north, Burlington Northern Santa Fe (BNSF) railroad right-of-way to the south, the former Crawford Oil to the west, and a vacant parcel of land to the east.

Briefly describe the site assessment that was conducted (number of borings, monitoring wells, number of samples, depth of soil samples and monitoring wells, analysis, etc.)

The site assessment consisted of three soil borings (MW-1 through MW-3) which were field-screened using a photo ionization detector (PID). A soil sample was collected from each boring at the location with the highest PID reading or immediately above the water table. The depth intervals at which the soil samples were collected are 8-10 feet in MW-1, 6-8 feet in MW-2, and 2-4 feet in MW-3.

After completion of the soil borings, monitoring wells were installed in each boring. The wells were surveyed and groundwater depths and total well depths were recorded. This information was used to determine the groundwater flow gradient and direction. Based on this information, groundwater generally flows to the northeast.

All soil and groundwater samples were analyzed for benzene, toluene, ethylbenzene, and xylene (BTEX), methyl tert-butyl ether (MTBE), total petroleum hydrocarbons (TPH), and total extractable hydrocarbons (TEH) using methods OA-1 and OA-2.

Summarize the findings and conclusions regarding the contaminants found and their extent and concentrations. Relate those values to known criteria such as statewide standards, MCLs, water quality standards, background levels or other benchmarks used to determine site priority.

Concentrations of benzene, ethylbenzene, xylene, TEH as diesel and TPH were detected in soil samples collected onsite. In addition, concentrations of benzene, ethylbenzene, xylene, TEH as fuel oil, and TPH were detected in groundwater samples collected onsite. None of the concentrations detected in soil or groundwater exceeded the applicable Tier 1 (Department) standards. Please see Tables 1 and 2 below for more details.

	Benzene	Toluene	Ethylbenzene	Xylene	MTBE	TEH-Diesel	TPH-Gasoline
MW-1 (8-10')	<0.002	<0.002	0.0073	0.0371	<0.002	14.2	27.4
MW-2 (6-8')	<0.01	<0.01	0.45	0.931	<0.01	29.4	444
MW-3 (2-4')	0.146	<0.01	0.0465	0.159	<0.01	69.7	76.6
Tier 1 Standards	0.54	42	15	NA	2,300	3,800	NA

	Benzene	Toluene	Ethylbenzene	Xylene	MTBE	TEH-Diesel	TPH-Gasoline
MW-1	<2	<2	<2	<2	<2	120	<100
MW-2	3.2	<2	2.5	3.9	<2	200	327
MW-3	<2	<2	<2	3.5	<2	<110	<100
Tier 1 Standards	5	1,000	700	10,000	21	1,200	NA

Identify on-site or off-site potential and actual targets (e.g., municipal wells, private wells, drinking water intakes). What is known of the neighboring area, i.e., are there residences, businesses, public use areas, etc.? Are there utility lines that could be impacted by site contaminants? Identify any other use/location issues that deserve consideration.

There are two wells located within a quarter-mile of the site, one municipal well (#1) at a depth of 2,290 feet and one plugged household well at a depth of about 32 feet. In addition, there are seven plugged monitoring wells located within a half-mile of the site ranging in depths from 14 to 20 feet. The site is also located within the five-year source water protection area for municipal well #1 located about 1,000 feet northeast of the site.

An unnamed tributary of the Campetina Creek is located about 1,000 feet north of the site. The surrounding site area appears to consist of mostly commercial and residential properties.

Rate the site on a scale of 1 to 4, in decreasing order of severity or priority.

4

Summarize the reasoning, knowledge or any other information used in determining your recommendation regarding the priority assigned to this site.

Based on the information provided in the Initial Site Characterization Report dated July 11, 2001, contaminant concentrations in excess of the applicable Tier 1 standards were not found in soil or groundwater onsite. Therefore, the site does not appear to pose a risk to human health or the environment.

No further action is required under CERCLA or Iowa Chapter 133 and the site is not a candidate for an ESS.

Form Reviewed:

Cel Lundberg

Date Reviewed:

3/12/07

PRE-CERCLIS SCREENING ASSESSMENT CHECKLIST/DECISION FORM

This checklist can assist the site investigator during the Pre-CERCLIS screening. It will be used to determine whether further steps in the site investigation process are required under CERCLA. Use additional sheets, if necessary.

Checklist Preparer: Tami Rice, Environmental Specialist 2/27/2007
(Name/Title) (Date)
502 East 9th Street, Des Moines, Iowa 50319 515-281-4420
(Address) (Phone)
tami.rice@dnr.state.ia.us
(E-mail Address)

Site Name: Kline Oil Company, Knoxville

Previous Names (if any): _____

Site Location: South of intersection at North Depot Street and West Ash Street

Knoxville Iowa 50138
(City) (ST) (Zip)
Latitude: 41.3232 **Longitude:** -93.1045

Compare the following checklist. If "yes" is marked, please explain below.

	YES	NO
1. Does the site already appear in CERCLIS?	<input type="checkbox"/>	<input checked="" type="checkbox"/>
2. Is the release from products that are part of the structure of, and result in exposure within, residential buildings or businesses or community structures?	<input type="checkbox"/>	<input checked="" type="checkbox"/>
3. Does the site consist of a release of a naturally occurring substance in its unaltered form, or altered solely through naturally occurring processes or phenomena, from a location where it is naturally found?	<input type="checkbox"/>	<input checked="" type="checkbox"/>
4. Is the release into a public or private drinking water supply due to deterioration of the system through ordinary use?	<input type="checkbox"/>	<input checked="" type="checkbox"/>
5. Is some other program actively involved with the site (i.e., another Federal, State, or Tribal program)?	<input type="checkbox"/>	<input checked="" type="checkbox"/>
6. Are the hazardous substances potentially released at the site regulated under a statutory exclusion (i.e., petroleum, natural gas, natural gas liquids, synthetic gas usable for fuel, normal application of fertilizer, release located in a workplace, naturally occurring, or regulated by the NRC, UMTRCA, or OSHA)?	<input type="checkbox"/>	<input checked="" type="checkbox"/>
7. Are the hazardous substances potentially released at the site excluded by policy considerations (e.g., deferral to RCRA Corrective Action)?	<input checked="" type="checkbox"/>	<input type="checkbox"/>
8. Is there sufficient documentation that clearly demonstrates that there is no potential for a release that could cause adverse environmental or human health impacts (e.g., comprehensive remedial investigation equivalent data showing no release above ARARs, completed removal action, documentation showing that no hazardous substance release have occurred, EPA approved risk assessment completed)?	<input type="checkbox"/>	<input checked="" type="checkbox"/>

Please explain all "yes" answer(s), attach additional sheets if necessary:

Petroleum products found onsite.

- Site Determination:**
- Enter the site into CERCLIS. Further assessment is recommended (Explain below).
 - The site is not recommended for placement into CERCLIS (Explain below).
 - Further assessment is recommended under PRE-CERCLA (Explain below).

DECISION/DISCUSSION/RATIONALE:
Based on the information provided in the Initial Site Characterization Report dated July 11, 2001, contaminant concentrations in excess of the applicable Tier 1 standards were not found in soil or groundwater onsite. Therefore, the site does not appear to pose a risk to human health or the environment.

No further action is required under CERCLA or Iowa Chapter 133 and the site is not a candidate for an ESS.

Regional EPA Reviewer:

Print Name/Signature Date

State Agency/Tribe:

CAL LUNDBERG Cal Lundberg 3/12/07
Print Name/Signature Date



REGION VII U.S. EPA SUPERFUND

SITE DISCOVERY ENTRY FORM

Discovery Lead (choose one):

Discovery Date: 7/11/2001 [] F-EPA Fund Fin [X] S-State Fund Fin [] FF-Fed Fac Removal [] EP-EPA-In-house [] TR Tribal Lead - Fund Fin

Site Name: Kline Oil Company, Knoxville Assessment [] States

Check if, [] FUD Site Initiated Date 2/27/2007 Identified By: [] Removal [X] Site

Address: South of intersection at North Depot Street and West Ash Street

[] Fed. Facilities [] Other Fed. Agency County Name: Marion

City, State, Zip: Knoxville, Iowa 50138

State ID (if one exists): Congressional District: 3

NPL Status: [] Currently on the Final NPL [X] Not on the NPL [] Deleted on the final NPL [] Pre-Proposal Site [] Site is Part of NPL Site [] Proposed for NPL [] Removed from Proposed NPL [] Withdrawn

Section: [] C-(STAR) SPFD Technical Assistannce/Re-Use Branch [X] L-(EFLR) Enfr/Fund Lead RV Branch Fed Fac Ind: [] Federal Facility [] F-(FFSE) Federal Facilities/Apecial Emphasis Brnach [] M-(MOKS) MO/KS Remedial Branch [] Not a Federal Facility [] I-(IANE) IA/NE Remedial Branch [] O-(ER&R) Emergency Response & RV Branch [] Status Undetermined

List Site Alias Name (s):

Directions to Site: Start on I-35 heading south. Merge onto IA-5 south via exit 68 toward West Des Moines / Airport. Merge onto IA-5 south via exit 72 toward Carlisle. Turn left onto IA-5 south / IA-92 east. Merge onto IA-964 toward IA-92 Business / Knoxville. Turn north onto North Grant Street and turn east on West Ash Street. The site is located on the south side of the street at the intersection of North Depot Street and West Ash Street.

Site Description: The site is owned by Burlington Northern Santa Fe (BNSF) Railway Company and was leased to Kline Oil Company for use as a bulk oil storage and transfer facility. Petroleum products were stored in aboveground storage tanks (ASTs).

Site Size: 4,000

Site Dimension: [] Acres [X] Square Feet [] Feet [] Square Miles [] Miles

USGS Quadrant: USGS Hydro Unit:

Latitude: 41.3232 Longitude: -93.1045 (Decimal Degree format/with release of 3.17 see attached required location data form)

Owner [] Bank/Loan Company [] Indian Lands Operator [] County Owned [] Other Type [] District Owned [X] Private [] Federally Owned [] Mixed Ownership [] Former Federally Owned or Operated [] State Owned [] Government Owned/Contractor Operated [] Trustee, Federal [] Privately Owned/Government Operated [] Trustee, State [] Property Defaulted Back to Government [] Municipality

Operational Status: [] Active [] Inactive [X] Unknown

Non-NPL Status (Choose one): [] Addressed as part of NPL site (AX) [] Combined PA/SI Ongoing (CO) [] Deferral of NPL Listing Dec. While States Oversee Resp. (SD) [] ESI Ongoing (EO) [] ESI Start Needed (ES) [] Fed Fac ESI Review Start Needed(FE) [] Fed Fac Prelim Assessment Rev Ongoing (PG) [] Fed Fac Prelim Assessment Rev Start Needed(PN) [] Fed Fac Site Inspection Rev Ongoing (FG) [] Fed Fac Site Inspection Rev Start Needed (FS) [] HRS Ongoing (HO) [] HRS Package Completed-Further Eval. Needed (HN) [] HRS Start Needed (HS) [] Integrated ESI RI Ongoing (IO) [] Integrated ESI/RI Start Needed (IS) [] Integrated Removal/Remedial Eval Ongoing (IN) [] Integrated Removal/Remedial Eval Start Needed (IR) [X] NFRAP (NF) [] Other Cleanup Activity: Fed Fac-lead Cleanup (OF) [] Other Cleanup Activity: Private Party-Lead Cleanup(OP) [] Other Cleanup Activity: State-Lead Cleanup (OS) [] Other Cleanup Activity: Tribal-lead Cleanup (OT) [] PA Ongoing (PO) [] PA Start Needed (PS) [] Ref to Rvl-Further Assess Needed (RW) [] Referred to Rvl - NFRAP (RR) [] Removal Only Site (No Site Assess Work) (RO) [] SI Ongoing (SO) [] SI Start Needed (SS) [] SIP Ongoing (SG) [] SIP Start Needed (SN) [] Site Reassessment Ongoing (SR) [] Status Not Specified (SX) [] Site Reassessment Start Needed (RN)

Site Type: (Choose all that apply - for every main category chosen in bold at least one sub-category must be selected; if more than one main and sub category is selected indicate which is primary):

Primary designation: OT [] MP-Manufacturing/Processing/Maintenance - Applicable sub-categories: [] CA-Chemicals and allied products [] CG-Coal gasification [] CP-Coke production [] EP-Electric power generation and distribution. [] EE-Electronic/electrical equipment [] FT-Fabrics/textiles [] WP-Lumber and wood products/wood preserving/treatment [] MF-Metal fabrication/finishing/coating and allied industries [] OR-Oil and gas refining [] OP-Ordnance production [] PR-Plastics and rubber products [] PM-Primary metals/mineral processing [] RA-Radioactive products [] TA -Tanneries [] OT-Other-Description(needed): [] TS-Trucks/ships/trains/aircraft and related components [] MI-Mining - Applicable sub-categories [] CO-Coal [] ME-Metals [] NM-Non-metal minerals [] OG-Oil and Gas [] OT-Other-Description(needed): [] WM-Waste Management - Applicable sub-categories [] CL-Co-disposal landfill (municipal and industrial) [] ID-Illegal disposal/open dump [] IF-Industrial waste facility (non-generator) [] IL-Industrial waste landfill [] MD-Mine tailings disposal [] OT-Other-Desc.(needed): [] RW-Radioactive waste treatment, storage, disposal (non-generator) [X] OT-Other - Applicable sub-categories [] AG-Agricultural (e.g., grain elevator) [] CS-Contaminated sediment site with no identifiable source [] DC-Dust control [] OT-Other-Desc.(needed): [] GP-Ground water plume site with no identifiable source [] MO-Military/Other Ordinance [X] PS-Product storage/distribution [] RD-Research, development, and testing facility [X] RC-Retail/commercial [] SE-Spill or other one-time event [] TP-Transportation (e.g., railroad yards, airport, barge docking, site) [] TW-Treatment works/septic tanks/other sewage treatment [] RE-Recycling - Applicable sub-categories [] AT-Automobiles/tires [] DT-Drums/tanks [] WO-Waste/used oil [] BS-Batteries/scrap metals/secondary smelting/precious metal recovery [] CC-Chemicals/chemical waste (e.g., solvent recovery) [] OT- Other-Description (needed):

Signatures:

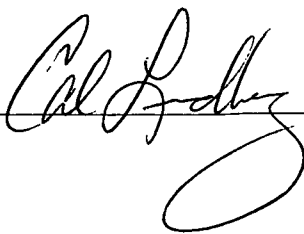

State: _____ Date: 3/12/07 RPM/OSC/SAM: _____ Date: / /



**REGION VII U.S. EPA SUPERFUND
NO DISCOVERY DATE**

PRE-CERCLIS INITIATION FORM

NPL Status = **O-NOT A VALID SITE OR INCIDENT**

Site Name: Kline Oil Company Identified By: _____

- Removal Site Assessment Federal Facilities States
 Other Federal Agency Check if FUD Site

Address: South of intersection at North Depot Street and West Ash Street

County Name: Marion

City, State, Zip: Knoxville, Iowa 50138

ID (if one exists): _____

Congressional District: 3

NPL Status: = : Not a Valid Site or Incident Federal Facility Indicator: Federal Facility Not a Federal Facility Status Undetermined

Section: C-(STAR) SPFD Technical Assistance/Re-Use Branch L-(EFLR) Enfr/Fund Lead RV Branch F-(FFSE) Federal Facilities/Special Emphasis Branch
 M-(MOKS) MO/KS remedial Branch I-(IANE) IA/NE Remedial Branch O-(ER&R) Emergency Response & RV Branch

List Site Alias Name (s): _____

Directions to Site: Start on I-35 heading south. Merge onto IA-5 south via exit 68 toward West Des Moines / Airport. Merge onto IA-5 south via exit 72 toward Carlisle. Turn left onto IA-5 south / IA-92 east. Merge onto IA-964 toward IA-92 Business / Knoxville. Turn north onto North Grant Street and turn east on West Ash Street. The site is located on the south side of the street at the intersection of North Depot Street and West Ash Street.

Site Description: The site is owned by Burlington Northern Santa Fe (BNSF) Railway Company and was leased to Kline Oil Company for use as a bulk oil storage and transfer facility. Petroleum products were stored in aboveground storage tanks (ASTs).

Site Size: 4,000

Site Dimension: Acres Square Feet
 Feet Square Miles Miles

USGS Quadrant: _____ USGS Hydro Unit: _____

Latitude: 41.3232 Longitude: -93.1045 CG-Coal gasification
(Decimal Degree format)-(with release of 3.17 see attached required location data form)

Lat/Long Accuracy: Seconds Miles Feet
 Degrees Minutes Kilometers Meters

Owner Bank/Loan Company Indian Lands
Operator County Owned Other
Type District Owned Private
 Federally Owned Mixed Ownership
 Former Federally Owned or Operated State Owned
 Government Owned/Contractor Operated Trustee, Feder
 Privately Owned/Government Operated Trustee, State
 Property Defaulted Back to Government
 Municipality

Operational Status: Active Inactive Unknown

Non-NPL Status (Choose one):

Not a Valid Site or Incident Not a Valid Site or Incident: NRC Lead
 Not a Valid Site or Incident: RCRA Lead Not a Valid Site or Incident: State Lead
 Not a Valid Site or Incident: Tribal Lead

Add Action: OU_00
: PRE-CERCLIS SCREENING Planned Complete: _____/_____/_____

Actual Complete: _____/_____/_____

Lead code (choose one):
 F-EPA Fund Financed FF - Federal Facility S - State, Fund Financed

SCAP Note: _____

Add below Action (if No Further Action):
OU_00 Lead: EP
 PRE-CERCLIS ARCHIVE Actual Complete: _____/_____/_____

SCAP Note: _____
Comments: Site or Action: _____

Site Type: (Choose all that apply - for every main category chosen in bold at least one sub-category must be selected; if more than one main and sub category is selected indicate which is primary):

- Primary designation: OT
 MP-Manufacturing/Processing/Maintenance - Applicable sub-categories:
 CA-Chemicals and allied products
 CP-Coke production
 EP-Electric power generation and distribution.
 FT-Fabrics/textiles
 LW-Lumber and wood products/pulp and paper
 WP-Lumber and wood products/wood preserving/preserving/treatment
 MF-Metal fabrication/finishing/coating and allied industries
 OR-Oil and gas refining
 OP-Ordnance production
 PR-Plastics and rubber products
 PM-Primary metals/mineral processing
 RA-Radioactive products
 TA-Tanneries OT-Other-Description(needed): _____
 TS-Trucks/ships/trains/aircraft and related components
 MI-Mining - Applicable sub-categories
 CO-Coal ME-Metals NM-Non-metal minerals
 OG-Oil and Gas OT-Other-Description(needed): _____
 WM-Waste Management - Applicable sub-categories
 CL-Co-disposal landfill (municipal and industrial)
 ID-Illegal disposal/open dump
 IF-Industrial waste facility (non-generator)
 MD-Mine tailings disposal OT-Other-Desc.(needed)_____
 ML-Municipal solid waste landfill
 RW-Radioactive waste treatment, storage, disposal (non-generator)
 OT-Other - Applicable sub-categories
 AG-Agricultural (e.g., grain elevator)
 CS-Contaminated sediment site with no identifiable source
 DC-Dust control OT-Other-Desc (needed)_____
 GP-Ground water plume site with no identifiable source
 MO-Military/Other Ordinance
 PS-Product storage/distribution
 RD-Research,development,and testing facility
 RC-Retail/commercial
 SE-Spill or other one-time event
 TP-Transportation (e.g., railroad yards, airport, barge docking, site)
 TW-Treatment works/septic tanks/other sewage treatment
 RE-Recycling - Applicable sub-categories
 AT-Automobiles/tires DT-Drums/tanks WO-Waste/used
 BS-Batteries/scrap metals/secondary smelting/precious metal recovery
 CC-Chemicals/chemical waste (e.g., solvent recovery)
 OT-Other-Description(needed): _____

Signatures:

States: _____

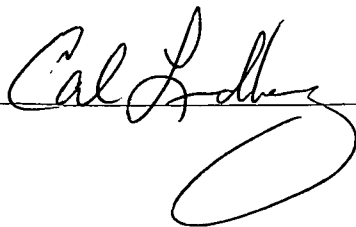

Date: _____

3,12,07

RPM/OSC/SAM: _____

Date: ____/____/____



REGION VII
U.S. ENVIRONMENTAL PROTECTION AGENCY

ENFORCEMENT SENSITIVE INFORMATION
FOR INTERNAL USE ONLY

LOCATION FORM - (Required information highlighted in red)

SITE NAME: Kline Oil Company, Knoxville

EPA ID: _____

Latitude: 41.3232
(Decimal Degree format)

Longitude: -93.1045

Measurement Sequence: _____
(See Comment A)

- Lat/Long Source: Contractor EPA Headquarters (Blank)
 Dun & Bradstreet Epic
 EPA Region 7 Other
 Geograph Private
 Other Federal Agency SNAP **Designate Lat/Long: Primary**
 Regulated Entity Tribe
 State Unknown

- Collection Method: Address Matching -House Number Address Matching - Block Face Address Matching - Street Centerline
 Address Matching -Nearest Intersection Address Matching - Primary Name Address Matching - Digitized
 Address Matching - Other Census Block - 1990 - Centroid Census Block/Group 1990-Centroid
 Census Block/Tract - 1990 - Centroid Classical Surveying Techniques Census - Other
 GPS Carrier Phase Static Relative Position GPS Carrier Phase Kinematic Relative Position GPS, with Canadian Active Control System
 GPS Code (Pseudo Range) Differential GPS Code (Pseudo Range) Precise Position GPS Code (Pseudo Range) Standard Position (SA-Off)
 GPS Code (Pseudo Range) Standard Position Service SA-On GPS-Unspecified Interpolation-Digital Map Source (TIGER)
 Interpolation-Map Interpolation -MSS Interpolation -Photo Interpolation - Satellite Interpolation - SPOT
 Interpolation-TM Interpolation - Other LORAN C Public Land Survey-Eighth Section Public Land Survey-Footing
 Public Land Survey-Quarter Section Public Land Survey-Section Public Land Survey-Sixteenth Section
 ZIP+2 Centroid ZIP+4 Centroid ZIP Code - Centroid (Blank) Unknown

- Reference Point: Administrative Building Air Monitoring Station Air Release Stack Air Release Vent
 Atmos. Emissions Trtmt Unit Boundary Point Building Entrance Facility/Centroid Cent Facility/Station Bldg Entrance
 Intake Point Lagoon or Settling Pond Liquid Waste Treatment Unit Loading Area Centroid Loading Facility
 Monitoring Point NE Corner of Land Parcel NW Corner of Land Parcel Other Plant Entrance (Freight)
 Plant Entrance (General) Plant Entrance (Personnel) Process Unit Area Centroid Process Unit SE Corner of Land Parcel
 Solid Waste Storage Area Solid Waste Trtmt/Disp. Unit Storage Tank SW Corner of Land Parcel Unknown
 Water Monitoring Station Water Release Pipe Well Well Protection Area (Blank) Release Point Treatment/Storage Plant

Reference Datum: NAD27 NAD83 Other Unknown WGS84 (Blank)

Accuracy Meters +/-: _____ Collection Date: ____/____/____

- Verification Method: Ground Truth Conducted Point In Polygon (County) Blank
 Point in Polygon (Zip) Proximity to Alternative Facility Coordinate Not Verified
 Proximity to Polygon Centroid(Other) Proximity to Polygon Centroid (Zip Code)
 Verified Relative to Map Features (1:100K/Tiger) Verified Relative to Map Features (1:24K)
 Verified Relative to Map Features (Other) Verified, Unknown Method
 Proximity to Polygon Centroid (County) Point in Polygon (Other)

Point/ Line/ Area: AREA LINE POINT REGION ROUTE (BLANK)

Source Map Scale: (BLANK) 1:10,000 1:12,000 1:15,840 1:20,000 1:24,000 1:25,000 1:50,000
 1:62,500 1:63,360 1:100,000 1:125,000 1:250,000 1:500,000 NONE UNKNOWN
 OTHER _____

COMMENTS: _____

Signatures:

RPM/OSC: _____ Date: ____/____/____ BRANCH CHIEF: _____ Date: ____/____/____

A) A sequential number to indicate the order in which points on a line or area are connected. For an area, the maximum point is connected to the first. Required if the feature is polygonal or linear. 3 numeric.

Kline Oil Company, Knoxville

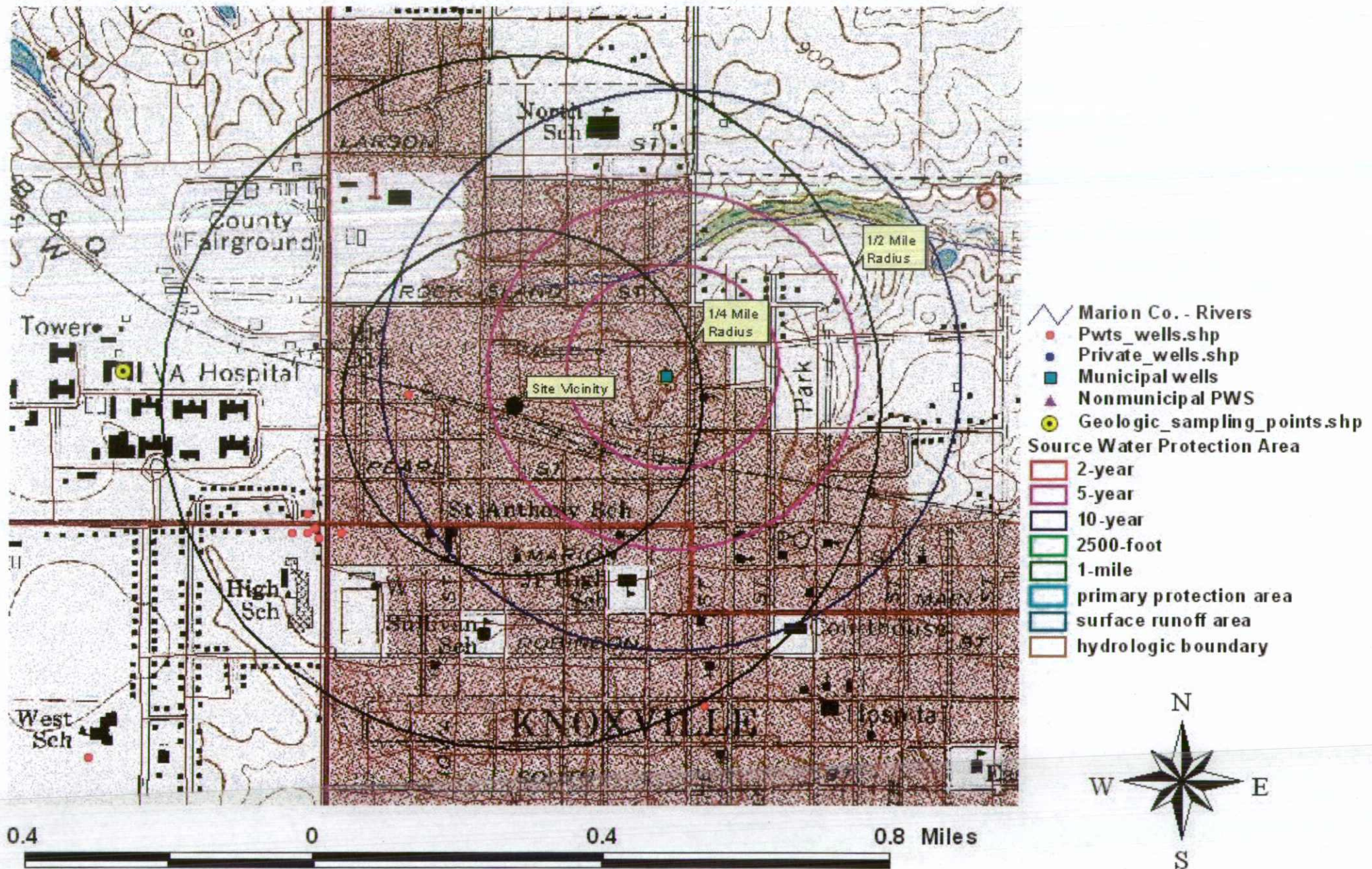

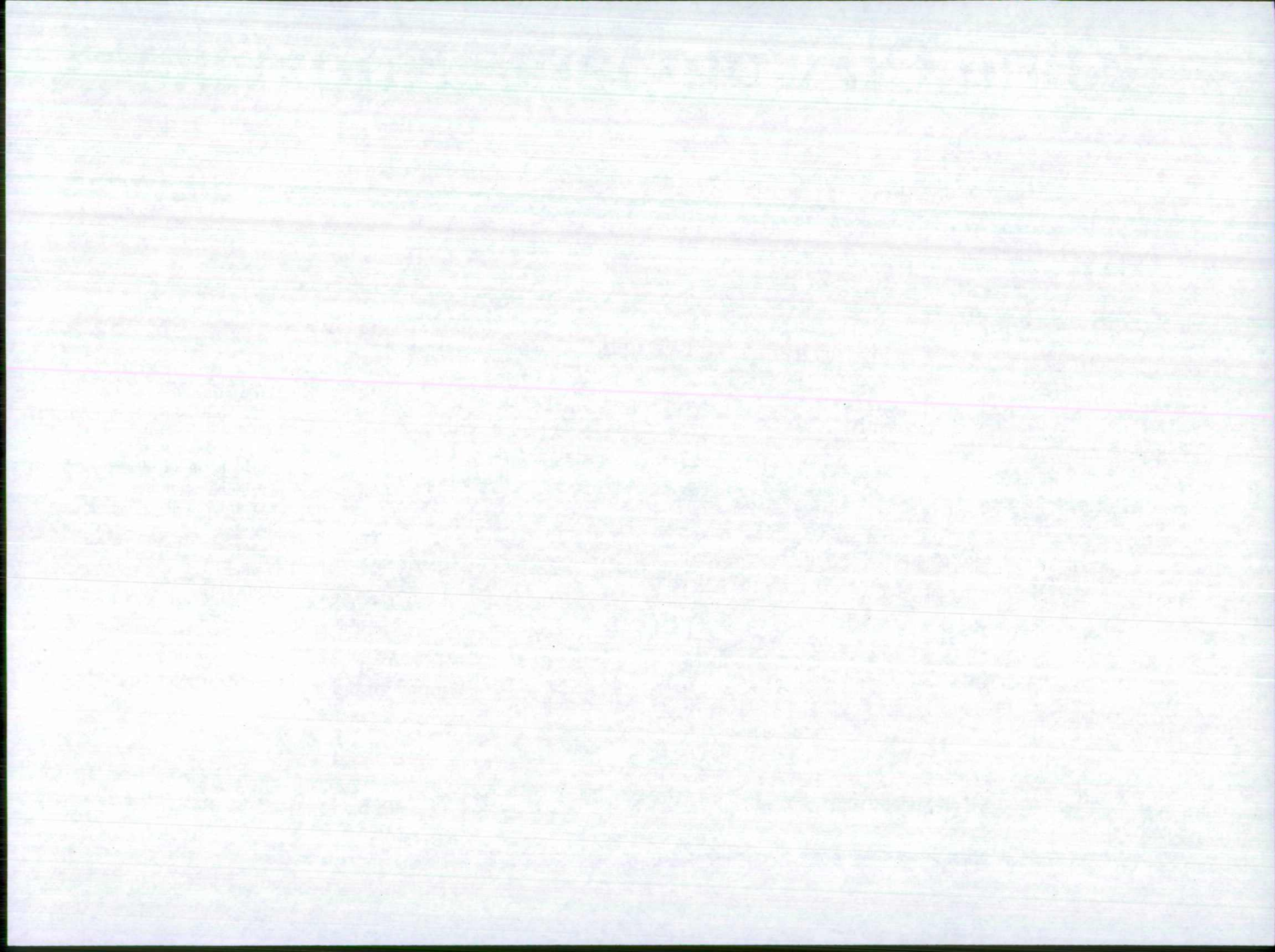

Kline Oil Company, Knoxville



- ∩ Marion Co. - Rivers
- Pwts_wells.shp
- Private_wells.shp
- Municipal wells
- ▲ Nonmunicipal PWS
- Geologic_sampling_points.shp
- Source Water Protection Area
 - 2-year
 - 5-year
 - 10-year
 - 2500-foot
 - 1-mile
 - primary protection area
 - surface runoff area
 - hydrologic boundary

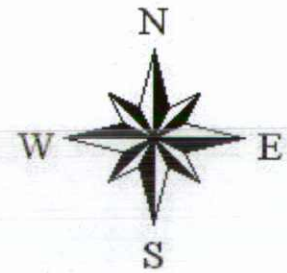

0.4 0 0.4 0.8 Miles

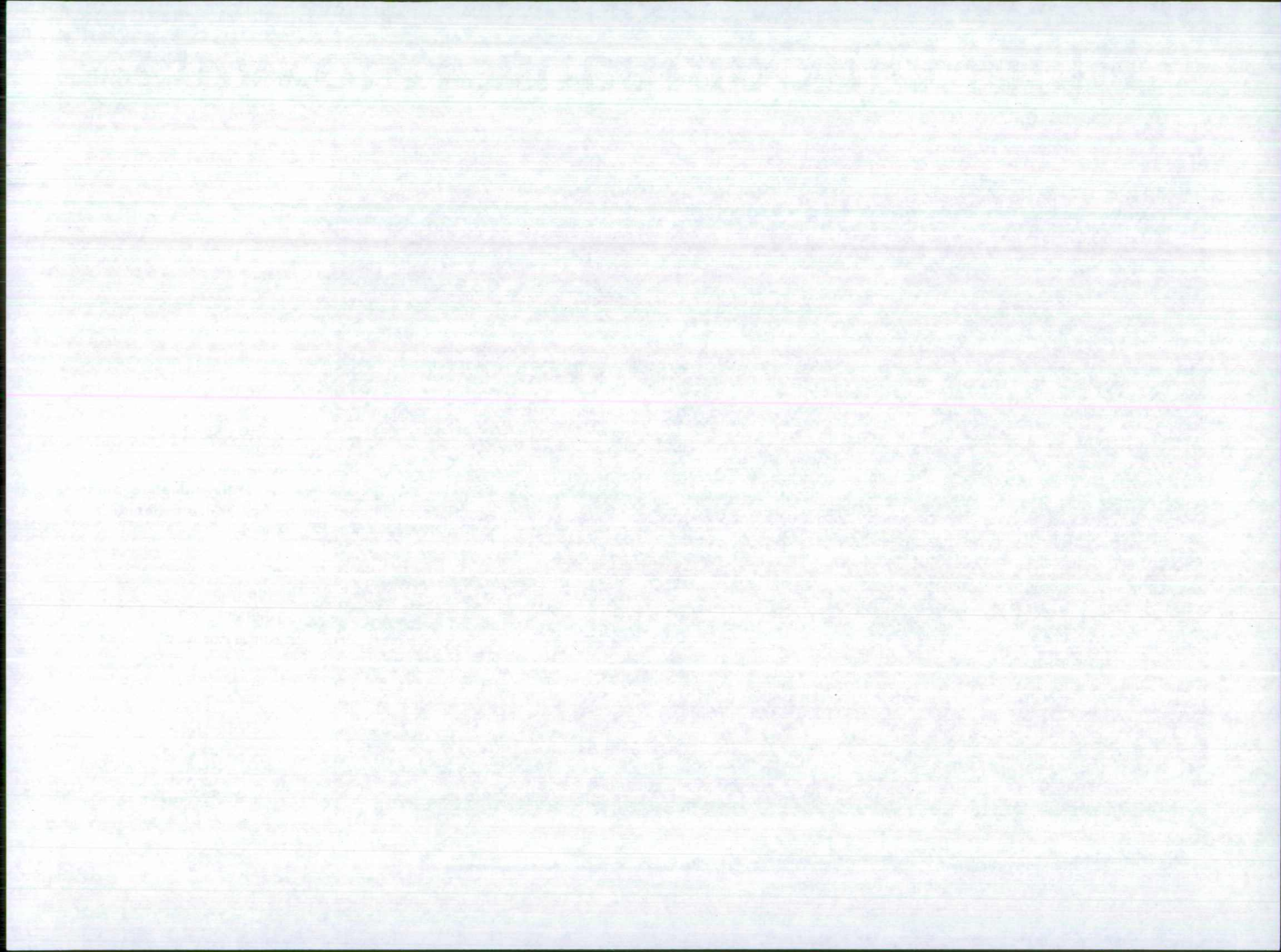

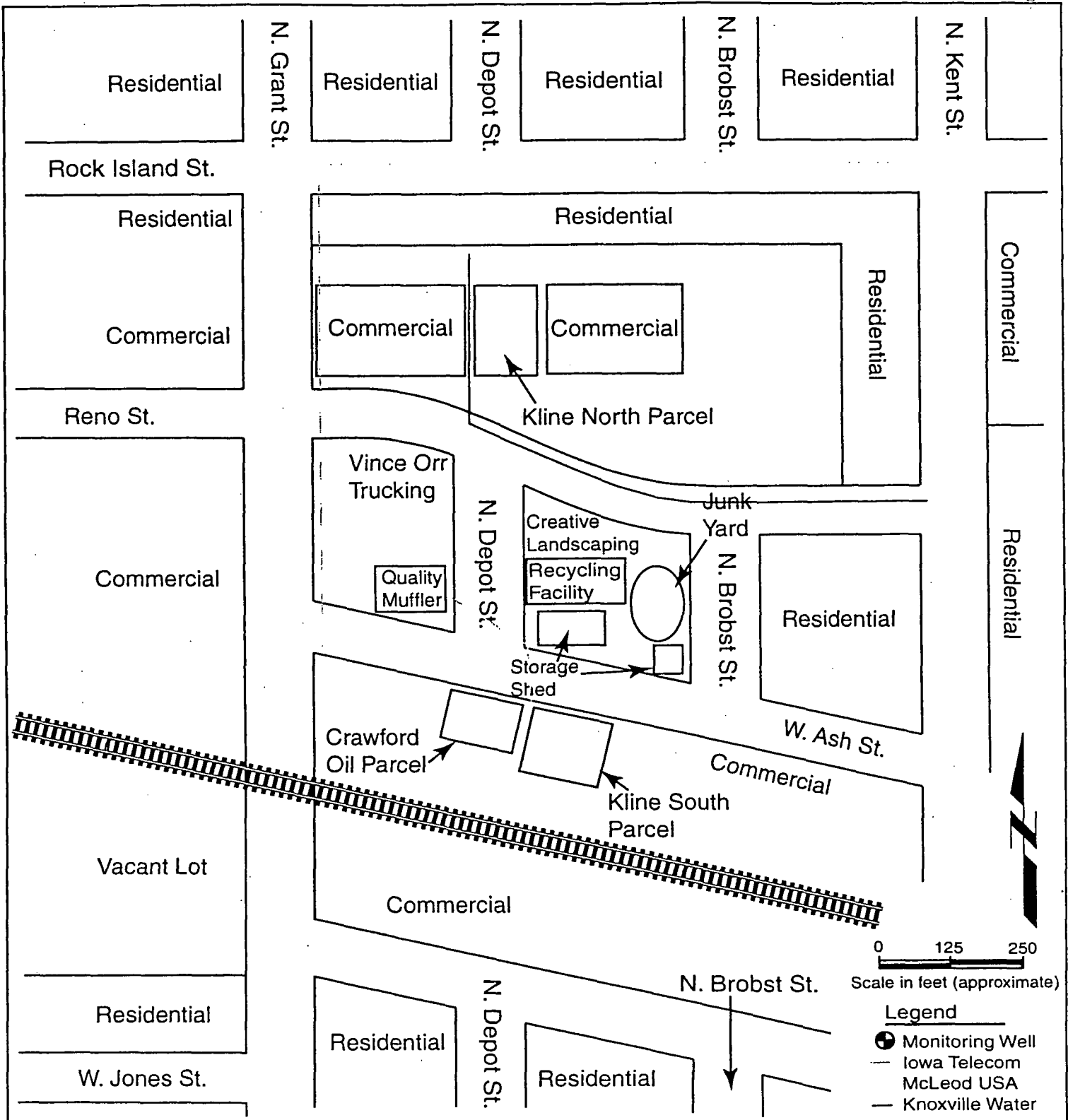

Figure No.
3

Kline South Parcel
Knoxville, IA
Lease Property No.: 580,277

Site Vicinity Map

DRAWN BY: beb DATE: 05/10/01
 CHECKED BY: kls REVISION NO.: 1
 PROJECT NO.: 5231.01 REFERENCE: _____



ENVIRONMENTAL MANAGEMENT RESOURCES

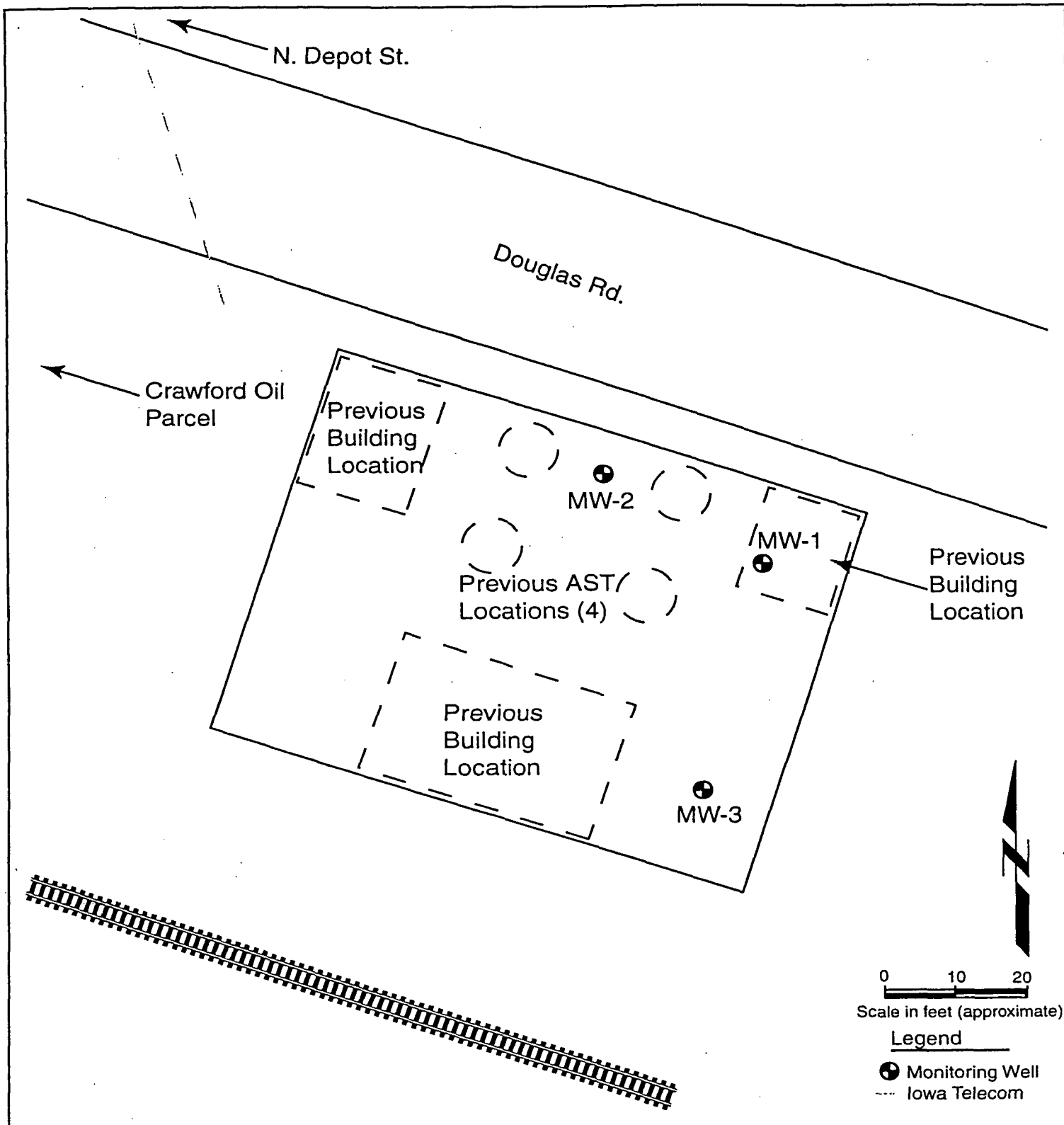

Figure No.
2

Kline South Parcel
Knoxville, IA
Lease Property No.: 580,277

Site Map

DRAWN BY: beb DATE: 05/10/01
 CHECKED BY: kls REVISION NO.: 1
 PROJECT NO.: 5231.01 REFERENCE: _____



ENVIRONMENTAL MANAGEMENT RESOURCES